

Copyright. All information furnished within this document, electronic file or design correspondence is the property of Den Hartog industries, Inc. and shall not be used, disclosed to others or copied without the expressed written consent of Den Hartog Industries, Inc.

KEY	PART NUMBER	DESCRIPTION	QTY
1	19558	1" FITTING RING WELDMET	1
2	19556	1" FITTING GASKET	2
3	19560	1.50" FITTING RING	1
4	19562	NUT, 3/8" FLANGE HEX 304 SS	4

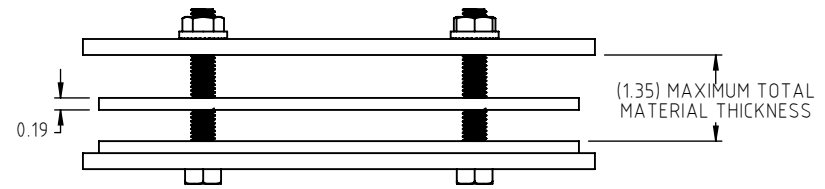

B	CHANGED MATERIAL DESCRIPTION	SAS	3/14/2024	4576	DRAWN / DATE ADH 9/26/2014	MATERIAL : [ⓑ] 316 STAINLESS STEEL WITH EPDM GASKET
A	REMOVE NOTE	BES	1/30/2023	4380	APPRD. / DATE REH 8/4/2015	
REV.	DESCRIPTION	BY	DATE	CCN		
ALL DIMENSIONS ARE IN DECIMAL INCHES TOLERANCES UNLESS OTHERWISE SPECIFIED		THIRD ANGLE PROJECTION ANSI 14.5M			SHOT WEIGHT:	NOTES: [Ⓐ]
POLYETHYLENE		METAL			SHIPPING WEIGHT:	
±1% @ 68°F		DECIMAL ± .125" FRACTION ± 1/4" ANGLE ± 1°			FINISH: NONE	

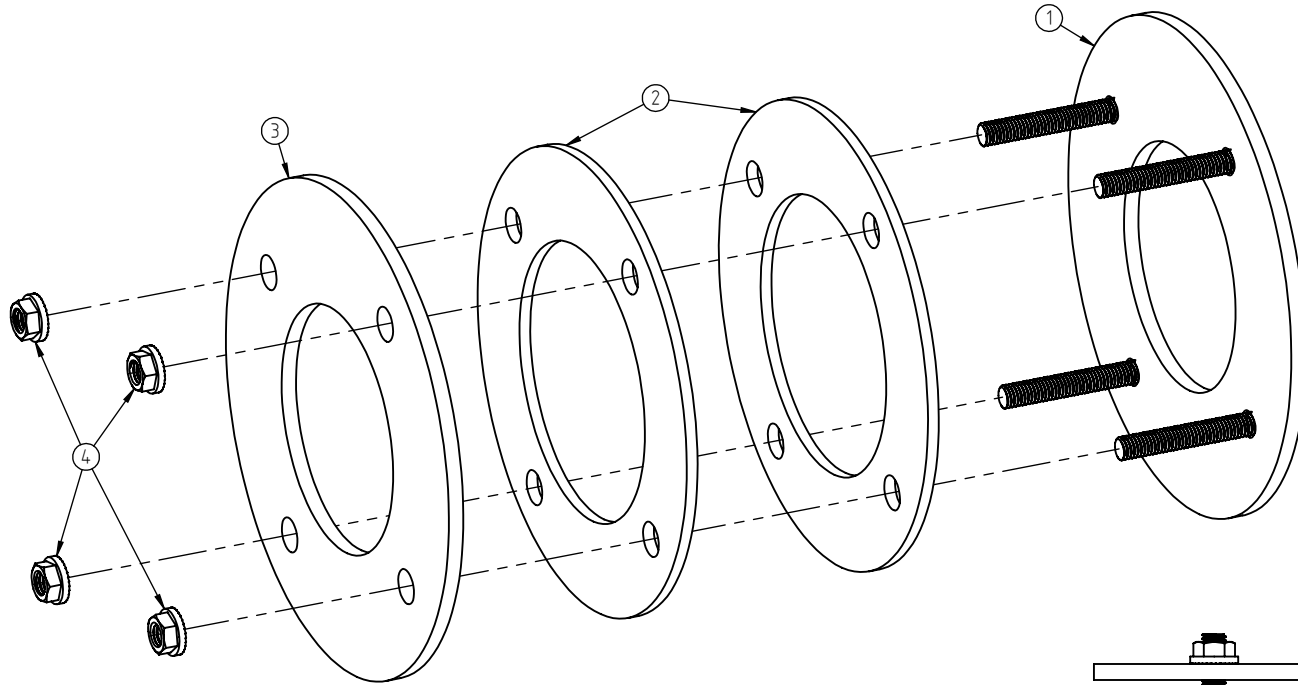

**Den Hartog
INDUSTRIES, INC.**

Ace Roto-Mold • Injection Molding • Blow Molding • Sowjoy
4010 HOSPERS DRIVE S. BOX 425, HOSPERS, IOWA 51238-0425

DESCRIPTION 1" DUALLINE TANK FITTING RING ASSEMBLY	
SCALE N.S.	PART NO. 19557
SHEET 1 OF 1	