

© DEN HARTOG INDUSTRIES, INC.

Copyright. All information furnished within this document, electronic file or design correspondence is the property of Den Hartog Industries, Inc. and shall not be used, disclosed to others or copied without the expressed written consent of Den Hartog Industries, Inc.

4860-16

G

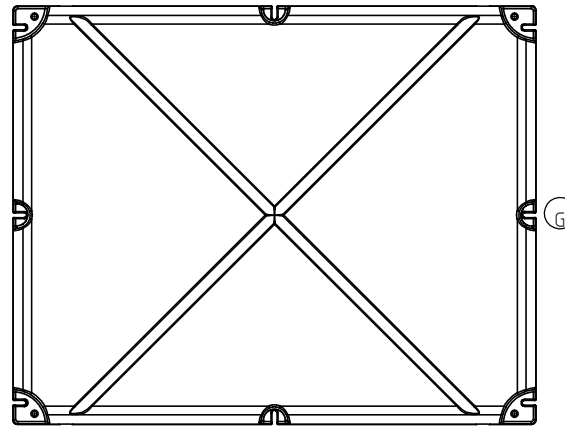
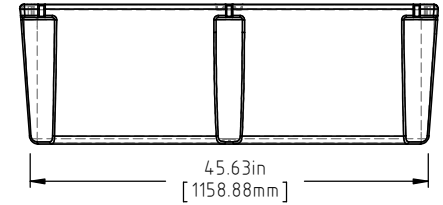
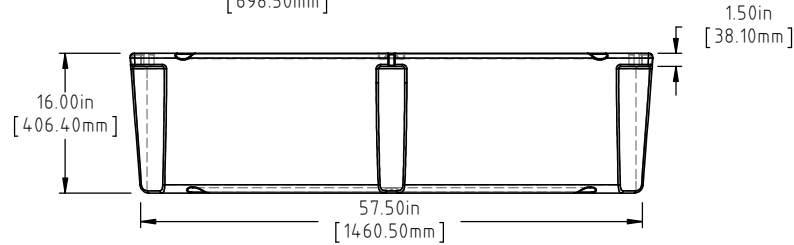
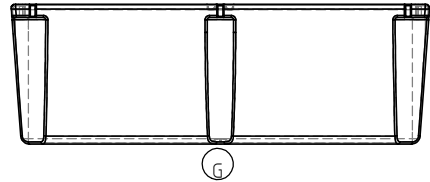
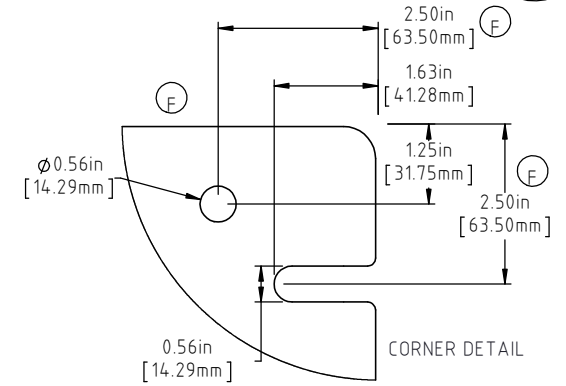
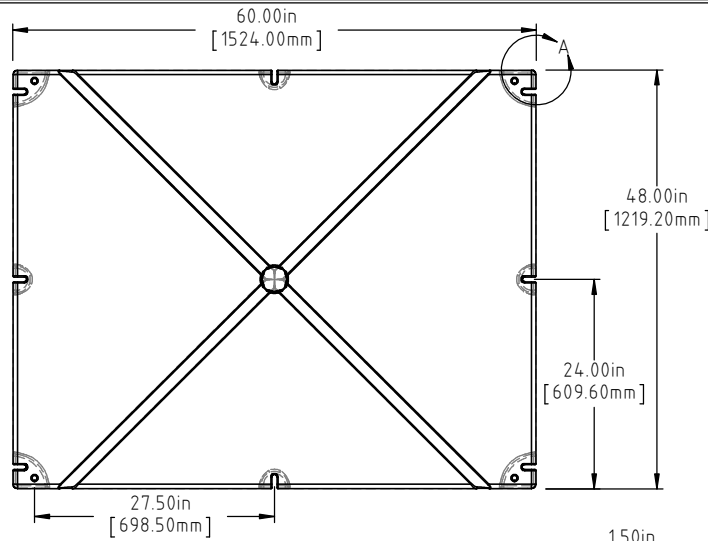

G	BOTTOM/SIDE VIEWS ADDED TO PRINT.	ADH 12/4/14	2971
F	CORNER SLOT ALIGNMENT CORRECTED. 2.50 WAS 2.75.	ADH 11/12/14	2956
E	80 LBS WAS 79 LBS, 14.97 LBS WAS 14.88 LBS	ADH 6/25/12	2420
D	METRIC DIMENSIONS ADDED	ADH 7/1/08	1685
C	ADD BUOYANCY NOTE	GWC 1/11/07	
B	CHANGE WEIGHTS AF WAS 55 FF WAS 84	GWC 1/11/07	
A	CHANGE SLOT ORIENTATION	DHJ 6/15/04	
REV	DESCRIPTION	BY / DATE	CCN

DRAWN / DATE	MATERIAL
DHJ 6/21/96	POLYETHYLENE
APPR. / DATE	
ADH 2/18/08	

NOTE: BUOYANCY IS 1497 LBS.(679.03 KG)



Den Hartog
INDUSTRIES, INC.

Ace Roto-Mold Injection Molding Blow Molding Sowjoy
4010 HOSPERS DRIVE S. BOX 425, HOSPERS, IOWA 51238-0425

ALL DIMENSIONS ARE IN DECIMAL INCHES TOLERANCES UNLESS OTHERWISE SPECIFIED
POLYETHYLENE
±1% @ 68°F

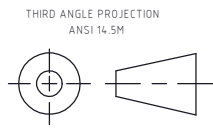

SHOT WEIGHT: 54 LBS. (24.49 KG.)
SHIPPING WEIGHT: SEE NOTES
FINISH:

NOTES (B)(E)
1.) AF 54 LBS. (24.49 KG.)
2.) FF 80 LBS. (36.29 KG.)
3.) 0.150 IN (3.81 mm) NOM. WALL

DESCRIPTION	48 X 60 X 16 FLOAT
SCALE	N.S.
PART NO.	4860-16