

Copyright. All information furnished within this document, electronic file or design correspondence is the property of Den Hartog industries, Inc. and shall not be used, disclosed to others or copied without the expressed written consent of Den Hartog Industries, Inc.

ITEM NO.	PART NUMBER	DESCRIPTION	QTY.
1	CB086-15ST-1	CONE SUPPORT STRAP	4
2	CB086-15ST-2	3" MILD STEEL CHANNEL (LEFT)	1
3	CB086-15ST-3	3" MILD STEEL CHANNEL (RIGHT)	1
4	CB086-15ST-4	3" MILD STEEL CHANNEL	2
5	CB086-15ST-5	BASE TUBING	6
6	CB086-15ST-6	1/2 OF CONE (HOLES)	1
7	CB086-15ST-7	1/2 OF CONE	1
8	CB086-15ST-8	CHANNEL RING	1
9	CB086-15ST-9	LEG-POWDER COAT	2
10	12521	CB, Ø12" STAND	1
11	12750	LEG PAD, 1/4" X 4" X 4"	6

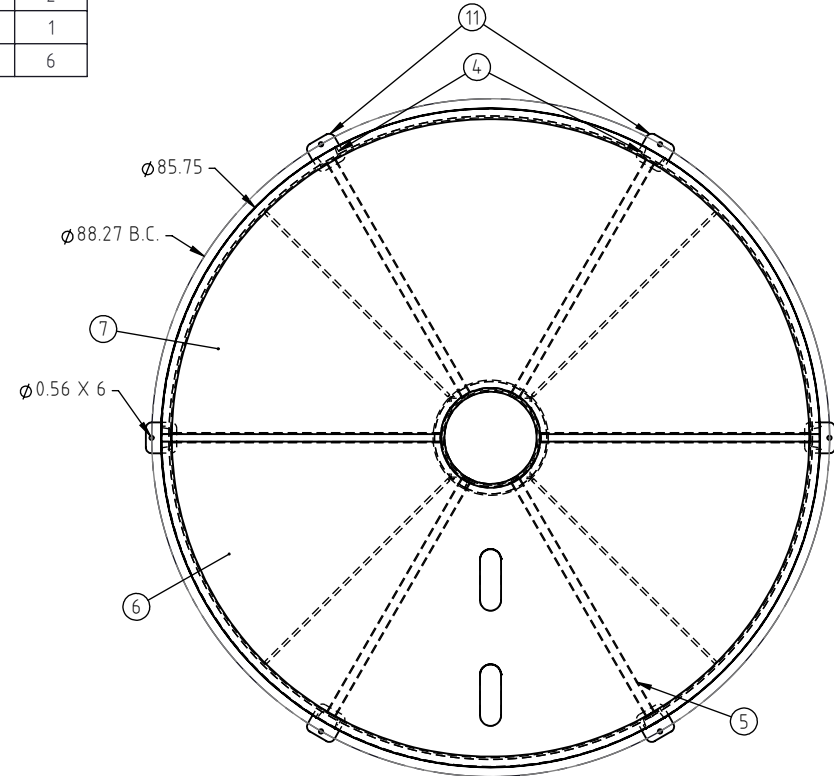
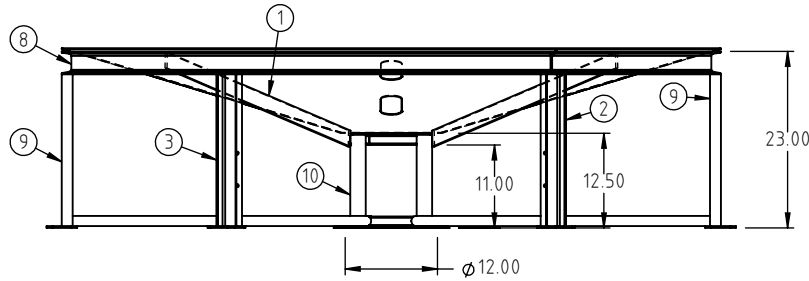

G

G	UPDATED SHEET FORMAT	SRA	7/21/2023	4447	DRAWN / DATE	ADH 6/19/2007	MATERIAL :	SEE COMPONENTS
F	HOLES FOR POWDER COATING ADDE TO TWO LEGS, PART TABLE FORMAT ADJUSTED	ADH	7/22/2011	2254	APPRD. / DATE	REH 6/28/2007		
E	COMPONENT TABLE UPDATED, TUBE SHORTENED 0.13"	ADH	7/2/2010	2051				
REV.	DESCRIPTION	BY	DATE	CCN				
ALL DIMENSIONS ARE IN DECIMAL INCHES TOLERANCES UNLESS OTHERWISE SPECIFIED		THIRD ANGLE PROJECTION ANSI 14.5M			SHOT WEIGHT:		NOTES:	
POLYETHYLENE		METAL			SHIPPING WEIGHT:			
±1% @ 68°F		DECIMAL ± .125" FRACTION ± 1/4" ANGLE ± 1°			360.00 LBS			
					FINISH:		Powder Coat	



Den Hartog
INDUSTRIES, INC.

Ace Roto-Mold • Injection Molding • Blow Molding • Sowjoy
4010 HOSPERS DRIVE S. BOX 425, HOSPERS, IOWA 51238-0425

DESCRIPTION		CB, STAND 86" DIA 15 DEG	
SCALE	N.S.	PART NO.	CB086-15ST
		SHEET	1 OF 1