

PROPRIETARY DATA

CB090-30ST

D

PROPERTY OF ACE ROTO-MOLD MFG., INC. INFORMATION FURNISHED HEREIN IS THE PROPERTY OF ACE ROTO-MOLD MFG., INC. AND SHALL NOT BE USED, DISCLOSED TO OTHERS, OR COPIED WITHOUT THE EXPRESSED WRITTEN CONSENT OF ACE ROTO-MOLD MFG., INC. ALL RIGHTS RESERVED.

KEY	PART NUMBER	MATERIAL	DESCRIPTION	QTY.
1	CB090-30ST-1	SJCB090-PANBASE	14 GA MILD STEEL SHEET	2 @ 24' X 48 IN (<2304 SI)
2	CB090-30ST-2	R05000	1/2" MILD STEEL ROD	168 IN
3	CB090-30ST-3	R05000	1/2" MILD STEEL ROD	72 IN
4	CB090-30ST-4	S-1875	3/16" MILD STEEL SHEET	2172 SI
5	CB090-30ST-5	C03X4.1	3" MILD STEEL CHANNEL	312 IN
6	12118	S-2500	1/4" MILD STEEL SHEET	4
7	CB090-30ST-7	A01875X15000	3/16" X 1 1/2" STEEL ANGLE	8 @ 36 IN (<288 IN)
8	CB090-30ST-8	C04X5.4	4" MILD STEEL CHANNEL	2 @ 69.75 IN (<139.5 IN)
9	CB090-30ST-9	C03X4.1	3" MILD STEEL CHANNEL	4 @ 64 IN (<256 IN)
10	CB090-30ST-10	P25000	2 1/2" SIZE TUBING	4 @ 36.5 IN (<146 IN)
11	CB090-30ST-11	B05000x60000	1/2" X 6" MILD STEEL FLAT	4 @ 1/2 X 6 X 6 IN (<144 SI)
12	CB090-30ST-12	C04X5.4	4" MILD STEEL CHANNEL	2 @ 73 IN (<146 IN)
13	CB090-30ST-13	R05000	1/2" MILD STEEL ROD	8 @ 3.5 IN (<28 IN)
14	CB090-30ST-14	A01875X15000	3/16" X 1 1/2" STEEL ANGLE	4 @ 5.5 IN (<22 IN)
15	CB090-30ST-15	R05000	1/2" MILD STEEL ROD	240 IN
16	CB090-30ST-16	S-10GA	10 GA KNOCK OUT	4

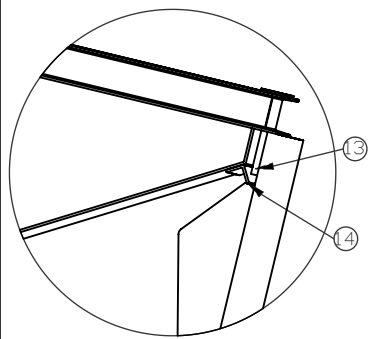
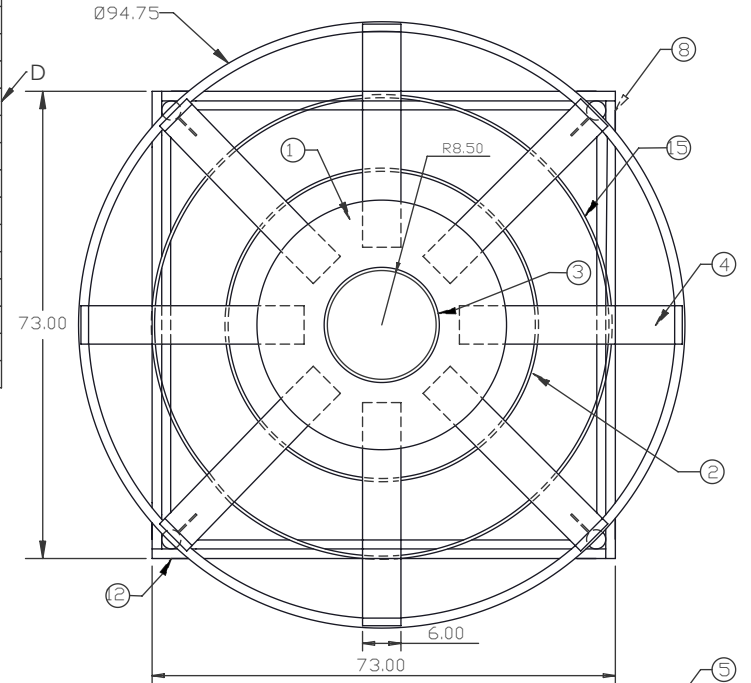

DETAIL D

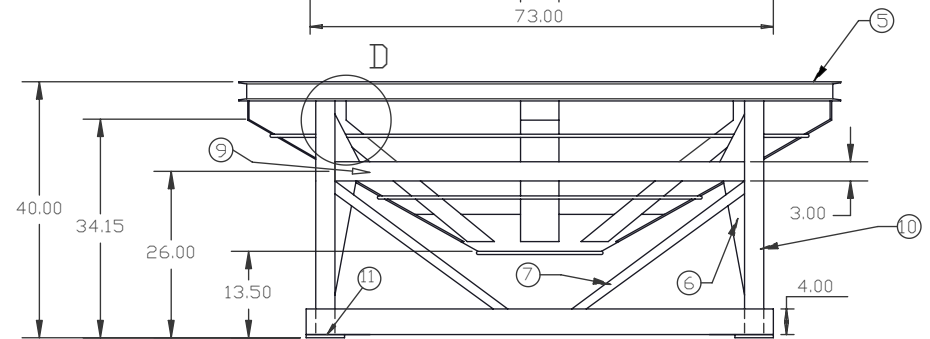
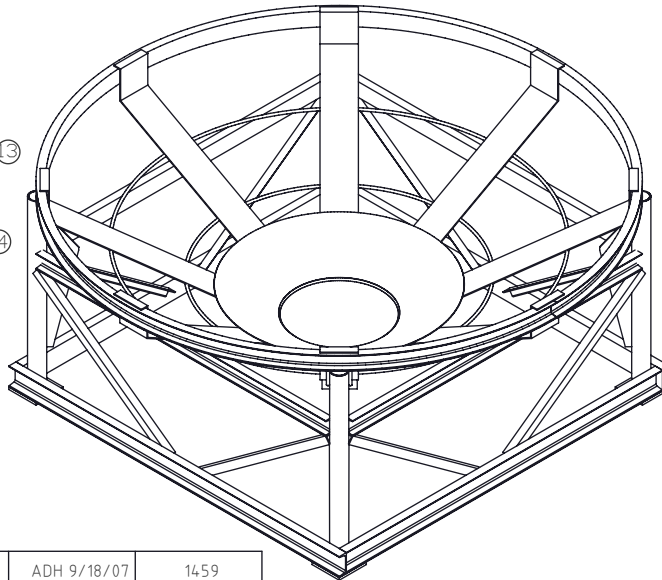

D	PART NUMBER CORRECTED	ADH 9/18/07	1459
C	S-14GA UPDATED TO SJCB090 P.B.	GWC 3/8/07	
B	TOLERANCE WAS 1% @ 68° F	GWC 3/8/07	
A	ISOLATED STAND, ADDED B.O.M.	NVE 6/6/06	
REV	DESCRIPTION	BY / DATE	CCN

DRAWN / DATE	MATERIAL
ADH 7/2/07	
APPRD. / DATE	
REH 7/18/07	



Den Hartog
INDUSTRIES, INC.

Ace Roto-Mold Injection Molding Blow Molding Sowjoy
4010 HOSPERS DRIVE S. BOX 425, HOSPERS, IOWA 51238-0421

ALL DIMENSIONS ARE IN DECIMAL INCHES
TOLERANCES UNLESS OTHERWISE SPECIFIED

DECIMAL ± .125"
FRACTION ± 1/4"
ANGLE ± 1°

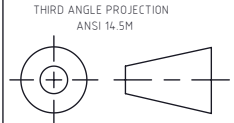

NOTES:

DESCRIPTION	CONE BOTTOM STAND FOR 30°, 90° TANK	
SCALE	N.S.	PART NO. CB090-30ST