

Copyright. All information furnished within this document, electronic file or design correspondence is the property of Den Hartog Industries, Inc. and shall not be used, disclosed to others or copied without the expressed written consent of Den Hartog Industries, Inc.

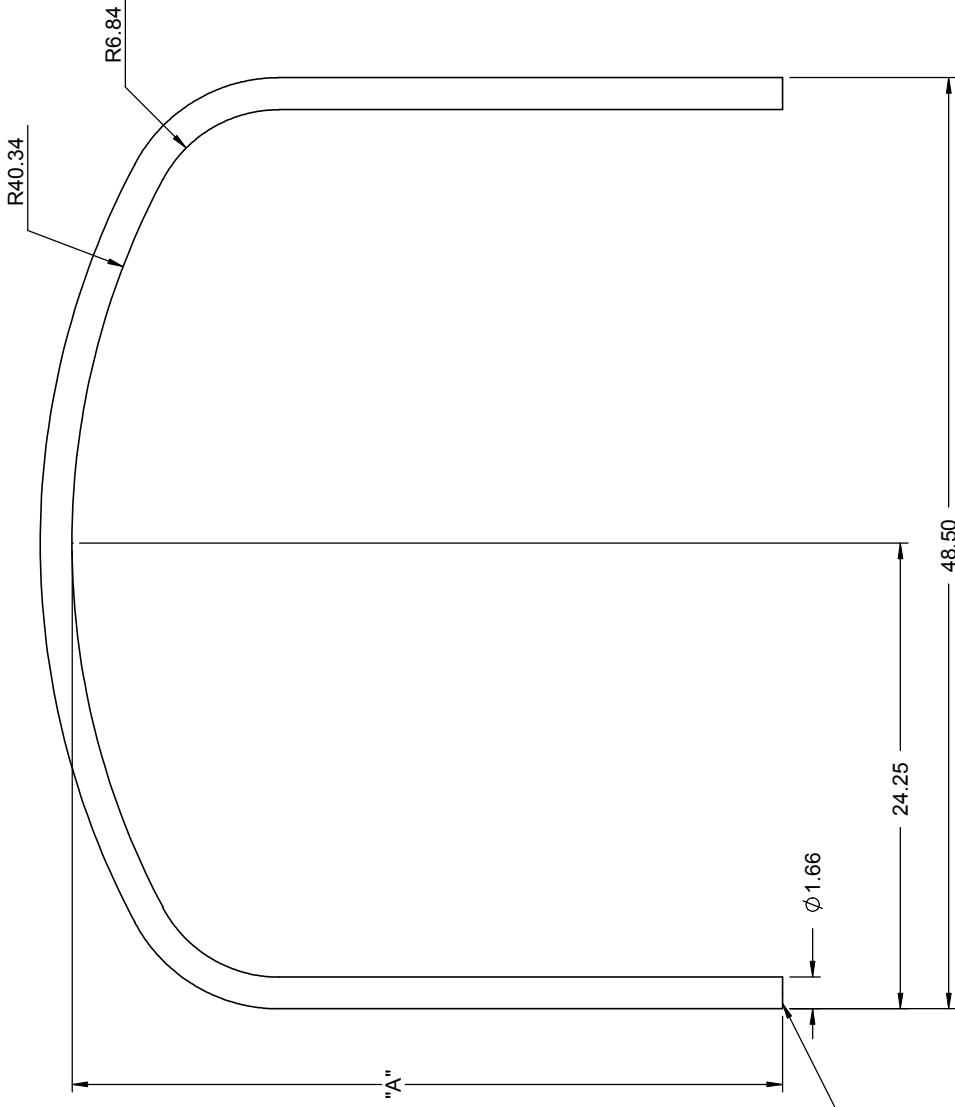

FINAL LENGTH OF HOOP AND CONNECTION BY CUSTOMER

TANK NO.	PART NO.	DIM. A	BLANK	WEIGHT
CC0500-48	CC0500-HP	25.00	85.34	14 lb.
CC0750-48	CC0750-HP	37.00	109.34	18 lb.

<p>Den Hartog INDUSTRIES, INC.</p> <p><small>Ace Roto-Mold Injection Molding Blow Molding Sowjoy</small> 4010 HOSPERS DRIVE S. BOX 425, HOSPERS, IOWA 51238-0421</p>		<p>DESCRIPTION UNIVERSAL 500-750 GALON CROP CARE TANK HOOPS</p>	
		<p>SCALE N.S. PART NO. CC0500-750-HP</p>	
<p>MATERIAL 1) TUBING, 1.66 RD MILD STEEL 12GA 2) CUT FROM T1660X01090</p>		<p>NOTES: 1) SHOT WEIGHT: 2) SHIPPING WEIGHT: 3) FINISH: UNPAINTED</p>	
<p>DRAWN / DATE ADH 3/19/09</p>		<p>BY / DATE CCN</p>	
<p>APPRD. / DATE REH 4/6/09</p>		<p>THIRD ANGLE PROJECTION ANSI 14.5H</p>	
<p>REV</p>		<p>DESCRIPTION ALL DIMENSIONS ARE IN DECIMAL INCHES TOLERANCES UNLESS OTHERWISE SPECIFIED METAL DECIMAL ± .125" FRACTION ± 1/4" ANGLE ± 1°</p>	