

© DEN HARTOG INDUSTRIES, INC.

Copyright. All information furnished within this document, electronic file or design correspondence is the property of Den Hartog Industries, Inc. and shall not be used, disclosed to others or copied without the expressed written consent of Den Hartog Industries, Inc.

OPTIONAL HOOP
AVAILABLE FOR MOUNTING
CC0500-HP

CM0500-48

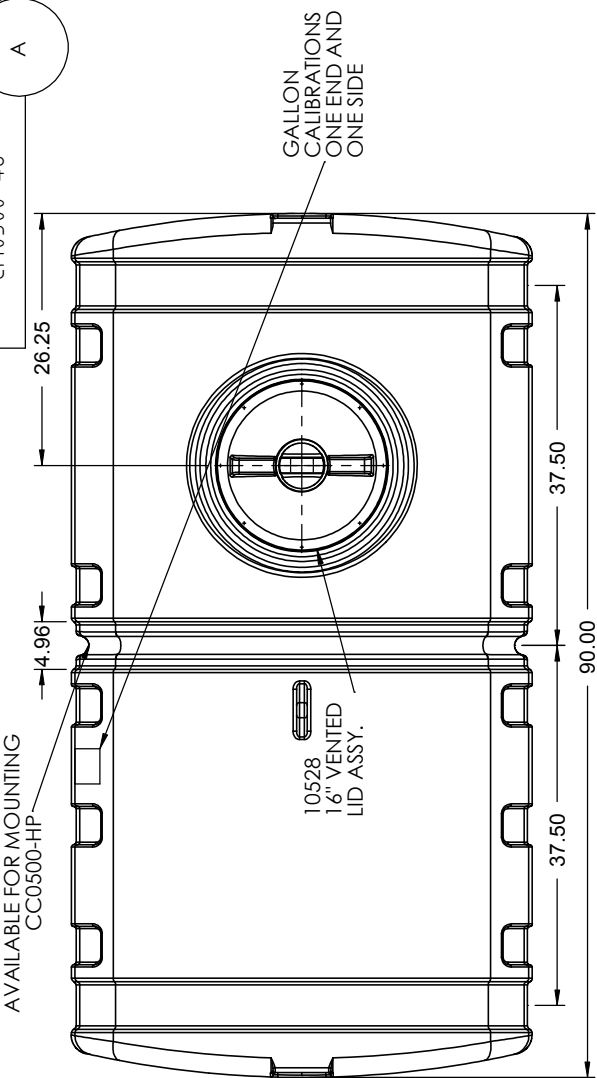

NOTE ON TANK MOUNTING:
USE A SINGLE HOOP IN THE CENTER TANK RECESS OR USE BANDS ON EACH END OF THE TANK FOR MOUNTING.

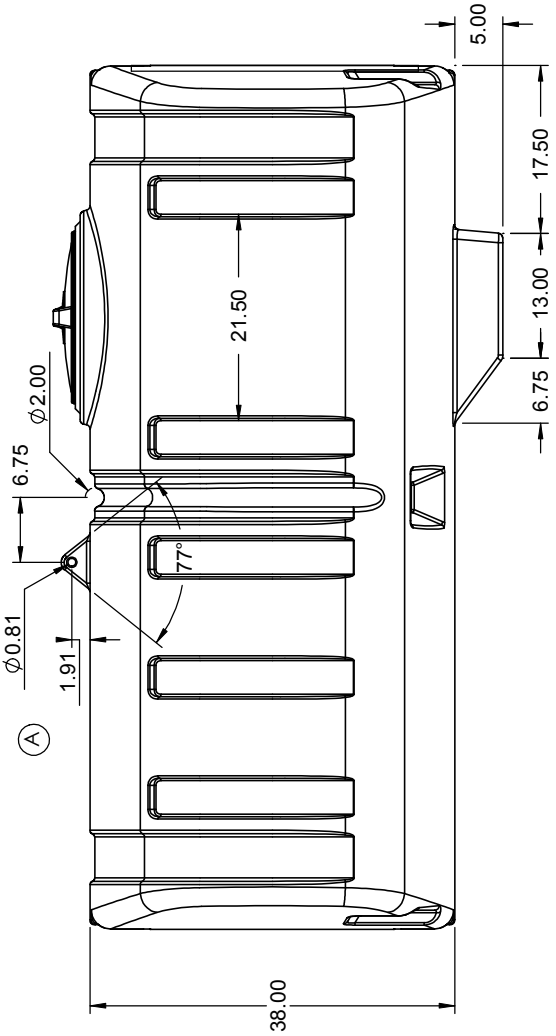
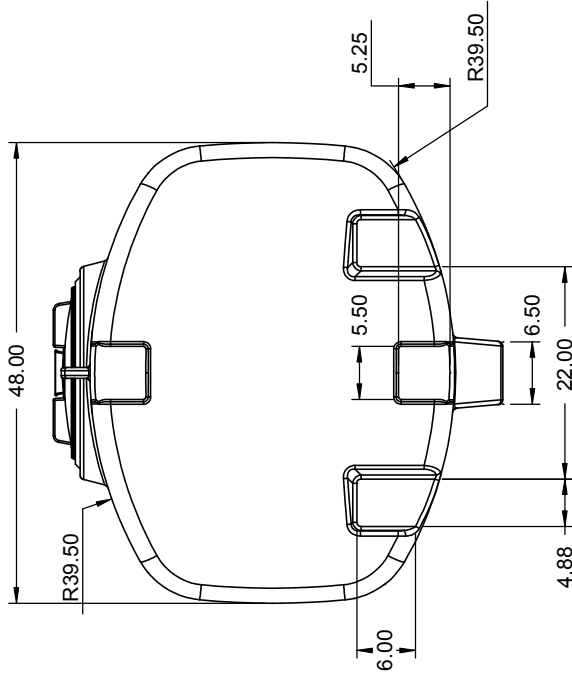

		Den Hartog INDUSTRIES, INC.		Ace Roto-Mold Injection Molding Blow Molding Sowjoy 4010 HOSPERS DRIVE S. BOX 425, HOSPERS, IOWA 51238-0421	
REV	DESCRIPTION	REH	BY / DATE	SHOT WEIGHT:	NOTES:
A	LIFTING LUG DETAILS ADDED	1846	REH 12/15/08	200 LBS	1.) NATURAL = 10538 2.) YELLOW = 10600
ALL DIMENSIONS ARE IN DECIMAL INCHES TOLERANCES UNLESS OTHERWISE SPECIFIED		THIRD ANGLE PROJECTION ANSI 14.5		FINISH: 1. .350 WALL	
POLYETHYLENE $\pm 1\%$ @ 68°F				DESCRIPTION 500 GALLON CROP CARE TANK SCALE N.S. PART NO. CM0500-48	