

Copyright. All information furnished within this document, electronic file or design correspondence is the property of Den Hartog Industries, Inc. and shall not be used, disclosed to others or copied without the expressed written consent of Den Hartog Industries, Inc.

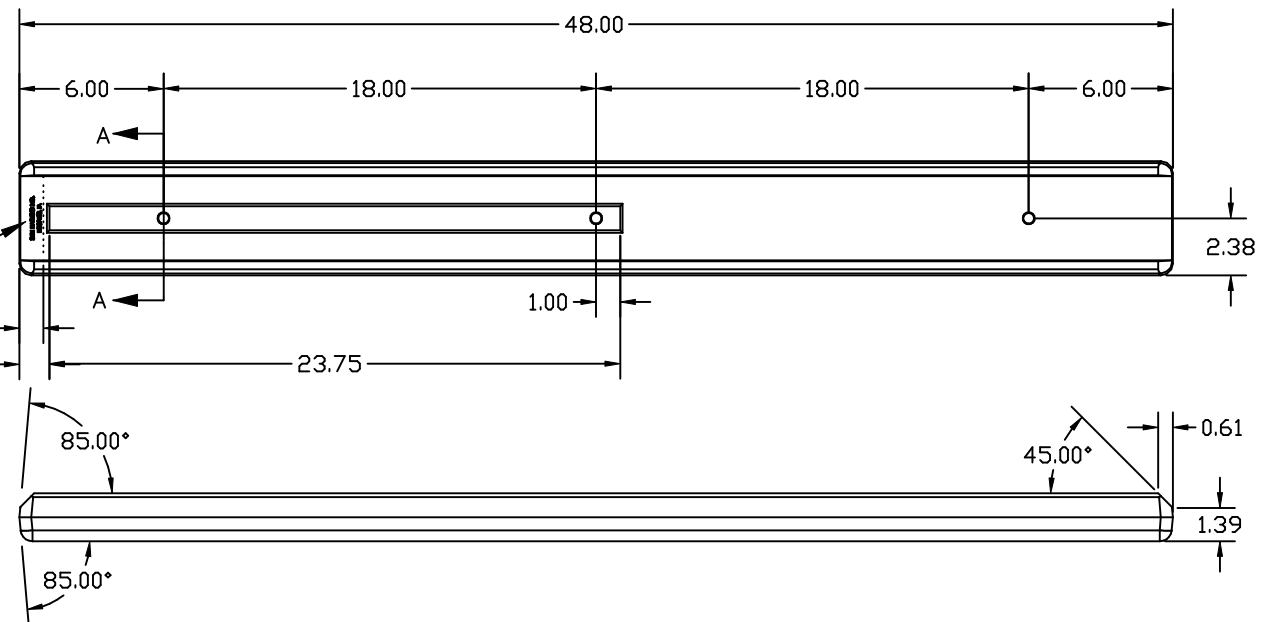

TEXT: 0.015' RAISED
TEXT TO BE WITHIN 1.00 OF END

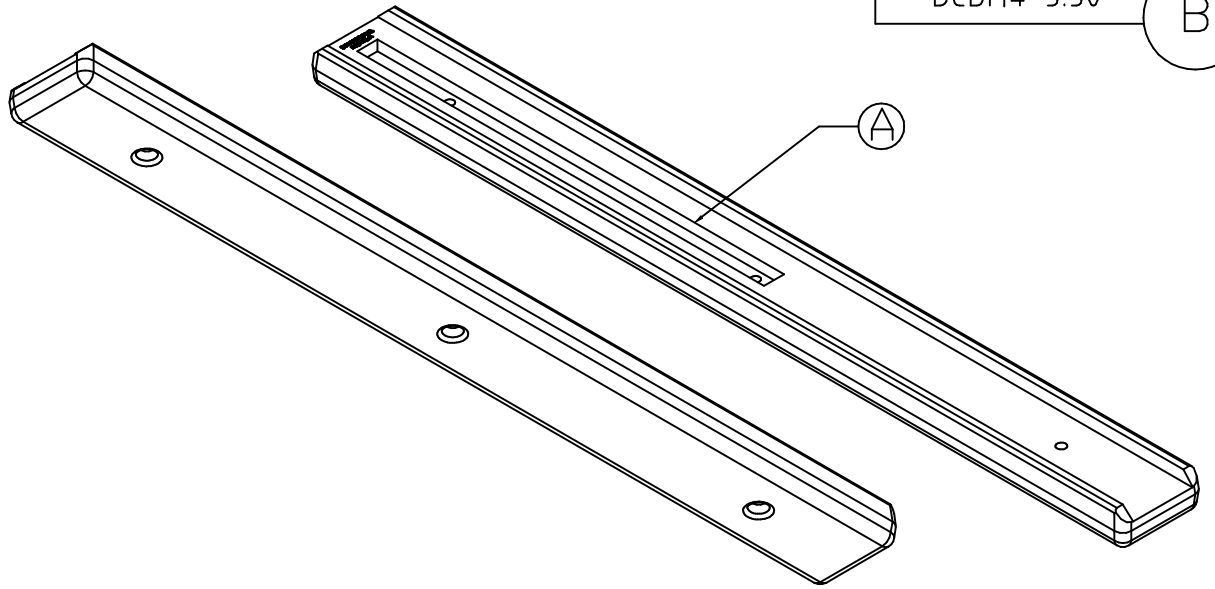
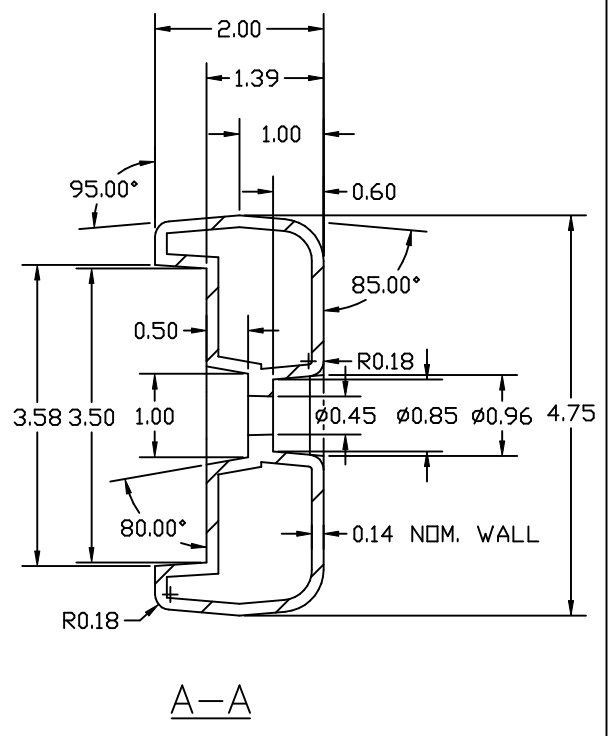
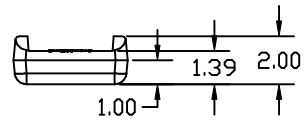

ALL RADII 0.50 UNLESS SPECIFIED

DRAWN / DATE NVE 5/25/06		MATERIAL ⑧ 80007=80% 80001=20%	
APPRD. / DATE ADH 11/8/07		NOTES: 1.) NOM. WALL @ .140 2.) COMPOUNDED U.V. INHIBITOR 3.) BLACK OR WHITE COLOR	
SHOT WEIGHT: 3.32 LBS.		SHIPPING WEIGHT:	
FINISH:		THIRD ANGLE PROJECTION ANSI 14.5M	
POLYETHYLENE ±1% @ 68° F		METAL DECIMAL ± .125" FRACTION ± 1/4" ANGLE ± 1°	



Den Hartog
INDUSTRIES, INC.

Ace Roto-Mold Injection Molding Blow Molding SawJoy
4010 HOSPERS DRIVE S. BOX 425, HOSPERS, IOWA 51238-0425

DESCRIPTION	BLOW-MOLDED 3.5" GROOVE BACK CUSHION - 4 FEET LONG		
SCALE	N.S.	PART NO.	DCBM4-3.50