

PROPRIETARY DATA

PROPERTY OF ACE FOTO-MOLD MFG., INC. INFORMATION FURNISHED HEREIN IS THE PROPERTY OF ACE FOTO-MOLD MFG., INC. AND SHALL NOT BE USED, DISCLOSED TO OTHERS, OR COPIED WITHOUT THE EXPRESSED WRITTEN CONSENT OF ACE FOTO-MOLD MFG., INC. ALL RIGHTS RESERVED.

FS1300-DW

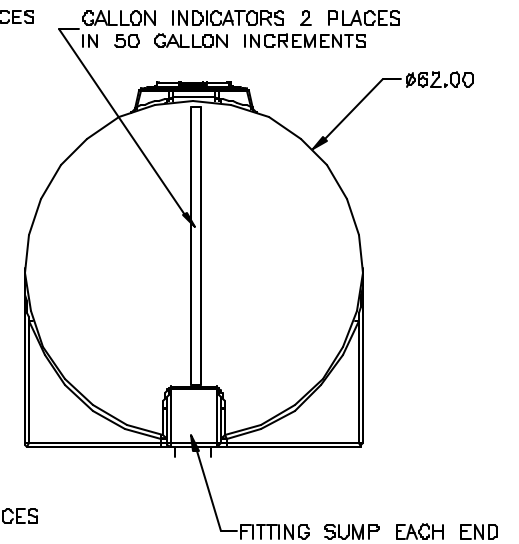
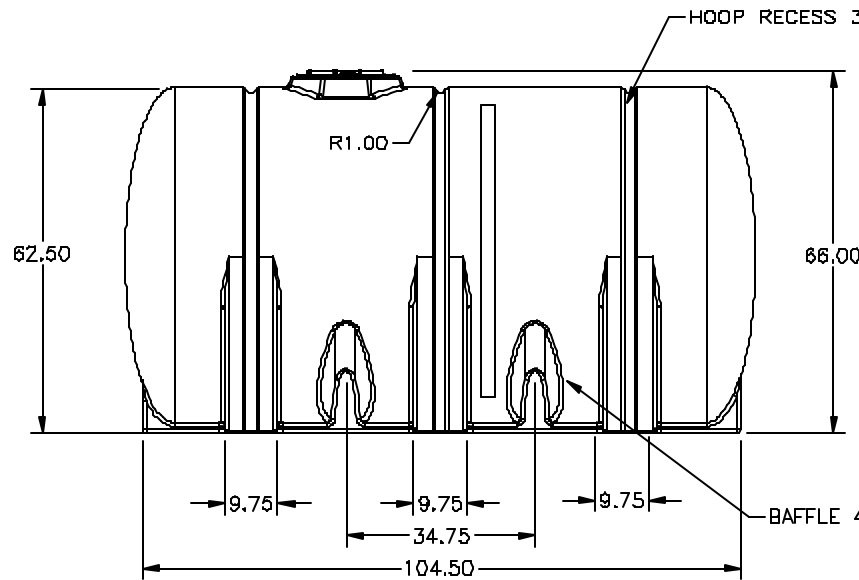
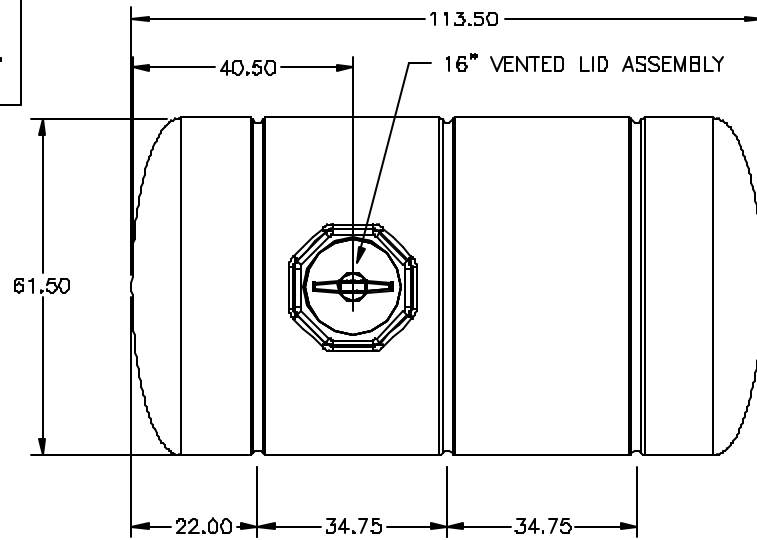

NOTE: 3 HOOPS ARE REQUIRED ON THIS TANK

REV	DESCRIPTION	DATE	APPRD

DRAWN / DATE REH/04/27/01
APPRD. / DATE REH/04/27/01

MATERIAL:  
425 LB. HDPE

**ACE FOTO-MOLD**  
A DIVISION OF DEN HARTOG INDUSTRIES, INC.  
4010 HWY. 60 BLVD., BOX 425 HOSPERS, IOWA 5123B

ALL DIMENSIONS ARE IN DECIMAL INCHES  
TOLERANCES UNLESS OTHERWISE SPECIFIED  
± 1% @ 68° F

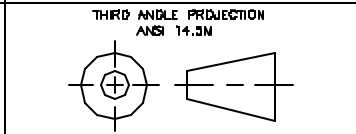

- NOTES:
1. AVAILABLE IN NATURAL OR YELLOW COLOR.
  2. NOM. WALL -.400

CLIENT / DESCRIPTION 1300 GAL. FREE STANDING LEG TANK	
SCALE N.S.	PART NO. FS1300-DW