

PROPRIETARY DATA

PROPERTY OF DEN HARTOG MFG, INC. INFORMATION FURNISHED HEREIN IS THE PROPERTY OF ACE ROTO-MOLD MFG, INC. AND SHALL NOT BE USED, DISCLOSED TO OTHERS, OR COPIED WITHOUT THE EXPRESSED WRITTEN CONSENT OF ACE ROTO-MOLD MFG, INC. ALL RIGHTS RESERVED.

KEY	PART NUMBER	MATERIAL	DESCRIPTION	QTY.
1	HZ0500-C-1	S-14GA	SHEET, 14GA	60" X 60" (3600 SI)
2	HZ0500-C-2	S-14GA	SHEET, 14GA	2 @ 13" X 60" (1560 SI)
3	HZ0500-C-3	B02500X30000	FLAT, 1/4" X 3"	2 @ 34.25" (68.5 IN)
4	HZ0500-C-4	B02500X15000	FLAT, 1/4" X 1 1/2"	4 @ 13" (52 IN)
5	SJHZ0232C-4	B02500X10000	FLAT, 1/4" X 1"	4 @ 3" (12 IN)
6	SJHZ0500C-1	A01875X30000	ANGLE, 3/16" X 3"	2 @ 34.25" (68.5 IN)

HZ0500-C

A

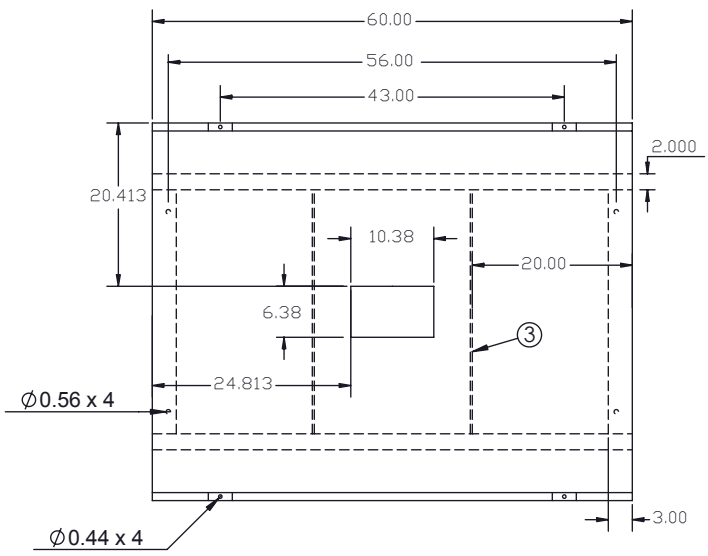

POWDER COATED STEEL BANDS TWO REQUIRED WITH J BOLTS



THICKENED TO .40 AT HOLES

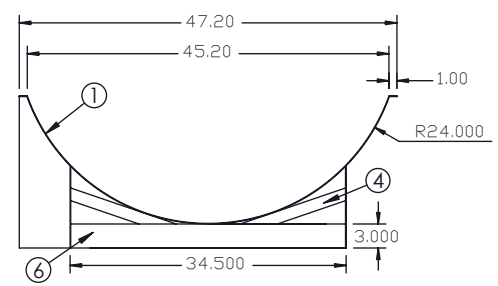
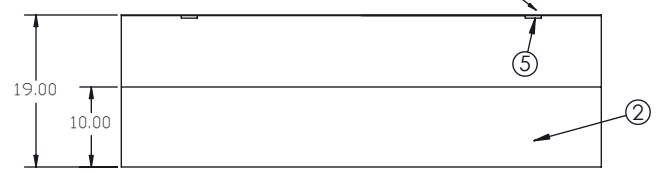

				DRAWN / DATE ADH 8/16/07	MATERIAL
A	TOLERANCE WAS 1% @ 68°F	GWC 3/15/07		APPRD. / DATE REH 11/26/07	
REV	DESCRIPTION	BY / DATE	CCN		
ALL DIMENSIONS ARE IN DECIMAL INCHES TOLERANCES UNLESS OTHERWISE SPECIFIED DECIMAL ± .125" FRACTION ± 1/4" ANGLE ± 1°				THIRD ANGLE PROJECTION ANSI 14.5M 	NOTES:



Den Hartog
INDUSTRIES, INC.

Ace Roto-Mold Injection Molding Blow Molding Sowjoy
4010 HOSPERS DRIVE S. BOX 425, HOSPERS, IOWA 51238-0421

DESCRIPTION	CRADLE FOR 500 GALLON HORIZONTAL TANK	
SCALE	N.S.	PART NO. HZ0500-C