

PROPRIETARY DATA

IN40/85-ST

H

PROPERTY OF ACE ROTO-MOLD MFG., INC. INFORMATION FURNISHED HEREIN IS THE PROPERTY OF ACE ROTO-MOLD MFG., INC. AND SHALL NOT BE USED, DISCLOSED TO OTHERS, OR COPIED WITHOUT THE EXPRESSED WRITTEN CONSENT OF ACE ROTO-MOLD MFG., INC. ALL RIGHTS RESERVED.

KEY	PART NUMBER	MATERIAL	DESCRIPTION	QTY.
1	IN40/85-ST-1	P10000	TUBING, 1" PIPE SIZE	4 @ 35.875 IN(143.5 IN)
2	IN40/85-ST-2	R03125	5/16" ROD	29 IN
3	IN40/85-ST-3	B01875X10000	3/16 X 1 FLAT	89.50 IN
4	12583	62202	PIPE PLUG, 1 INCH	4
5	IN40/85-ST-5	B02500X20000	1/4 X 2 FLAT	4 @ 24 IN (96 IN)
6	IN40/85-ST-6	B02500X10000	1/4 X 1 FLAT	4 @ 9.50 IN (38 IN)
7	IN40/85-ST-7	B02500X10000	1/4 X 1 FLAT	4 @ 16.50 IN (66 IN)

(F)(H)

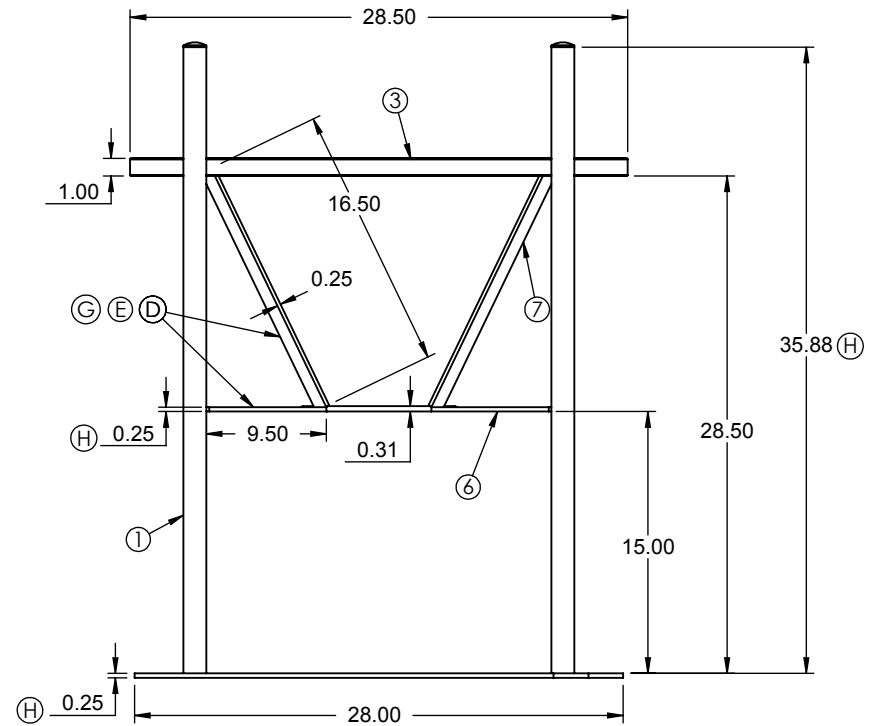
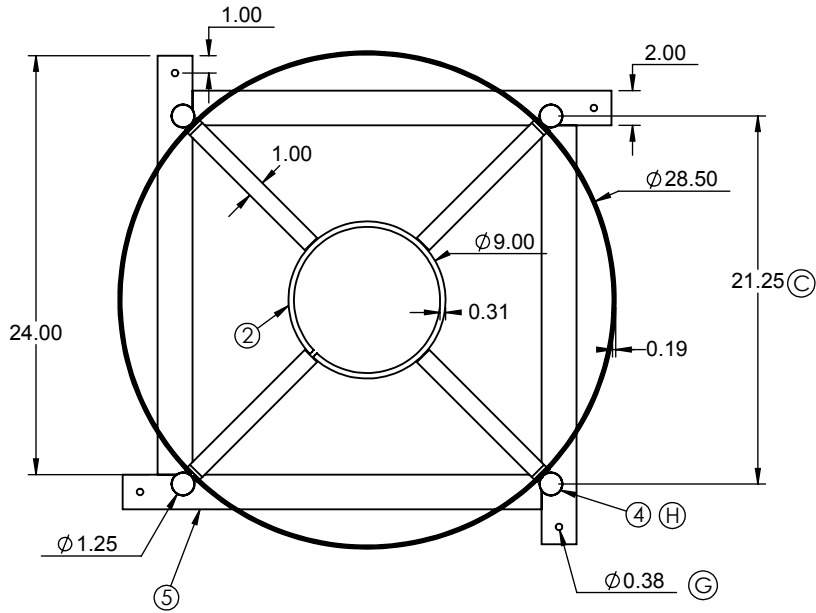

H	DIMENSIONS AND LEG PLUGS UPDATED	ADH 10/14/08	1729
G	HOLE DIA WAS .44 DIA.	ADH 3/28/08	1637
F	CORRECTED PART NUMBER	ADH 10/31/07	1506
E	LENGTH WAS 9.75 AND 17.00	ADH 6/25/07	
D	LENGTH WAS 9.50 AND 16.50	ADH 6/13/07	
C	WAS 21.00	DHJ 6/13/07	
B	TOLERANCE WAS 1% @ 68°F	GWC 3/15/07	
A	ADDED B.O.M.	NVE 6/9/06	
REV	DESCRIPTION	BY / DATE	CCN

DRAWN / DATE	MATERIAL
ADH 7/18/07	
APPRD. / DATE	
REH 10/5/07	



**Den Hartog**  
INDUSTRIES, INC.

Ace Roto-Mold Injection Molding Blow Molding Sowjoy

4010 HOSPERS DRIVE S. BOX 425, HOSPERS, IOWA 51238-0421

ALL DIMENSIONS ARE IN DECIMAL INCHES  
TOLERANCES UNLESS OTHERWISE SPECIFIED

DECIMAL ± .125"  
FRACTION ± 1/4"  
ANGLE ± 1°

THIRD ANGLE PROJECTION  
ANSI 14.5M

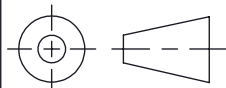

NOTES:

- 1.) POWDER COATING, BLACK TILE, 40012
- 2.) WEIGHT 40 LBS

DESCRIPTION 40,85,, OR 110 GALLON INDUCTOR STAND

SCALE N.S.

PART NO. IN40/85-ST