

© DEN HARTOG INDUSTRIES, INC.

Copyright. All information furnished within this document, electronic file or design correspondence is the property of Den Hartog industries, Inc. and shall not be used, disclosed to others or copied without the expressed written consent of Den Hartog Industries, Inc.

| KEY | PART NUMBER | DESCRIPTION | QTY. |
|-----|-------------|-------------------------------|------|
| 1 | SJ15500 | SUPPORT, END BAR | 2 |
| 2 | SJ15501 | SUPPORT, END 1/4" X 1/2" FLAT | 2 |
| 3 | SJ15502 | SUPPORT, CROSS | 3 |
| 4 | SJ15503 | SUPPORT, TAB 3-3/8" | 2 |
| 5 | SJ15504 | SUPPORT, TAB 3-3/4" | 2 |
| 6 | SJ15505 | SUPPORT, TAB 4" | 2 |
| 7 | SJ16008 | SUPPORT BAR, SIDE (FS-NUR) | 2 |

SJFPS001

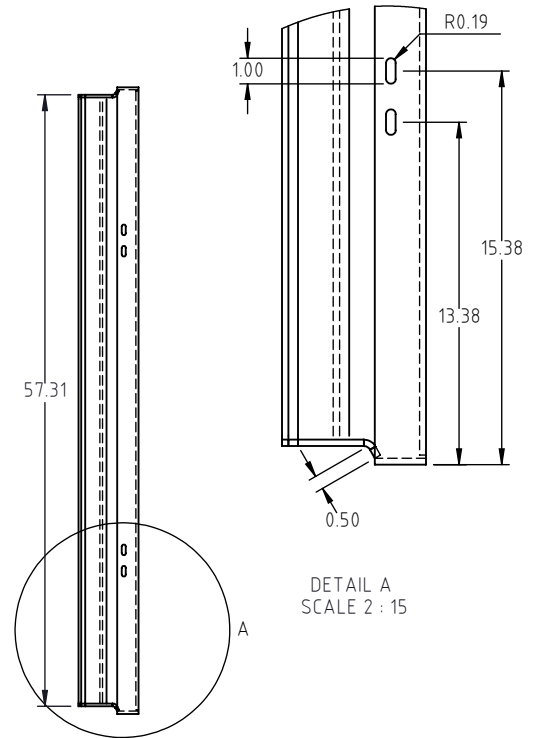
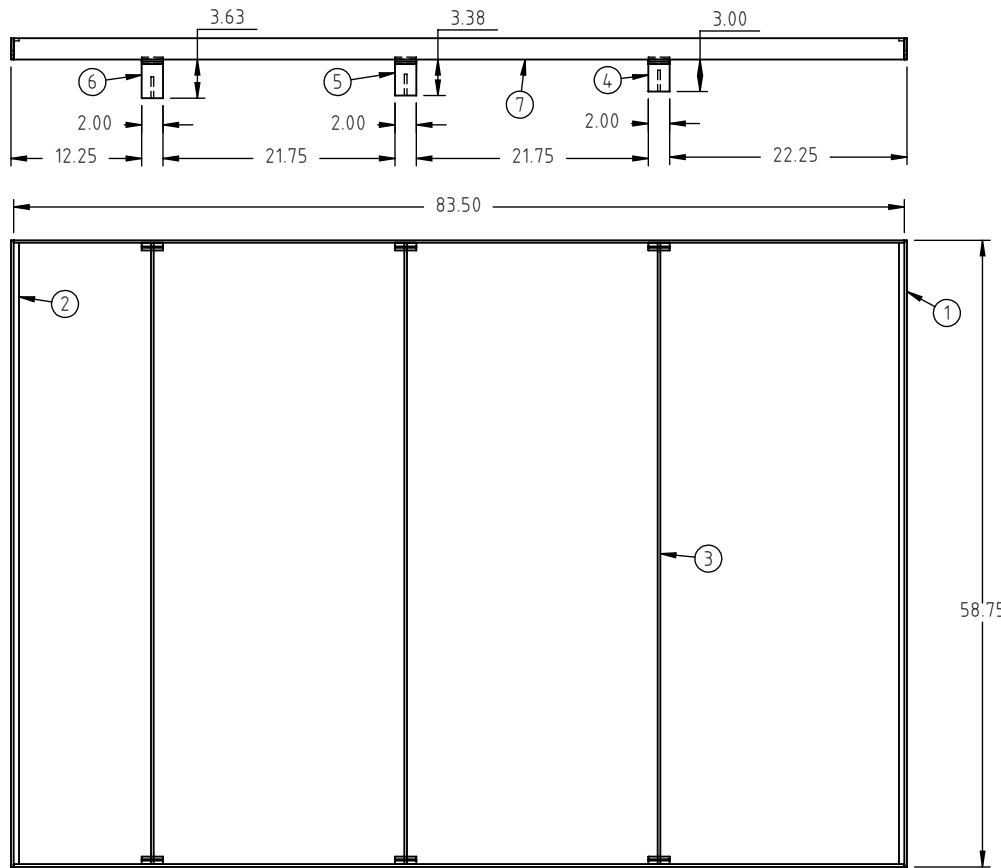

DETAIL A
SCALE 2 : 15

| | | | | | | | |
|---|--|---|--|--------------------------------------|-----|--------------------------------|----------|
| REV | | DESCRIPTION | | BY / DATE | CCN | DRAWN / DATE ADH 8/4/09 | MATERIAL |
| | | | | | | APPROD. / DATE KGJ 4/27/10 | |
| ALL DIMENSIONS ARE IN DECIMAL INCHES TOLERANCES UNLESS OTHERWISE SPECIFIED | | | | THIRD ANGLE PROJECTION ANSI 14.5M | | SHOT WEIGHT: | NOTES: |
| POLYETHYLENE | | METAL DECIMAL ± .125" FRACTION ± 1/4" ANGLE ± 1° | | ±1% @ 68° F | | SHIPPING WEIGHT: 72 LBS | |
| | | | | | | FINISH: RECLAIM POWDER COAT | |



Den Hartog
INDUSTRIES, INC.

Ace Roto-Mold Injection Molding Blow Molding Sowjoy

4010 HOSPERS DRIVE S. BOX 425, HOSPERS, IOWA 51238-0421

| | |
|--|----------------------|
| DESCRIPTION FLUSH PAN SUPPORT FRAME | |
| SCALE N.S. | PART NO. SJFPS001 |