

PROPRIETARY DATA

PROPERTY OF ACE ROTO-MOLD MFG., INC. INFORMATION FURNISHED HEREIN IS THE PROPERTY OF ACE ROTO-MOLD MFG., INC. AND SHALL NOT BE USED, DISCLOSED TO OTHERS, OR COPIED WITHOUT THE EXPRESSED WRITTEN CONSENT OF ACE ROTO-MOLD MFG., INC. ALL RIGHTS RESERVED.

TD0300-36

B

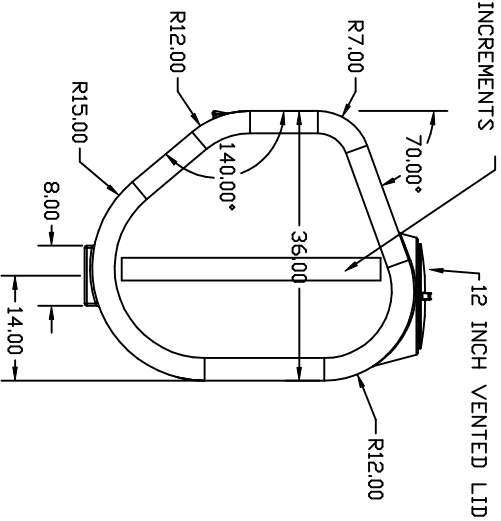
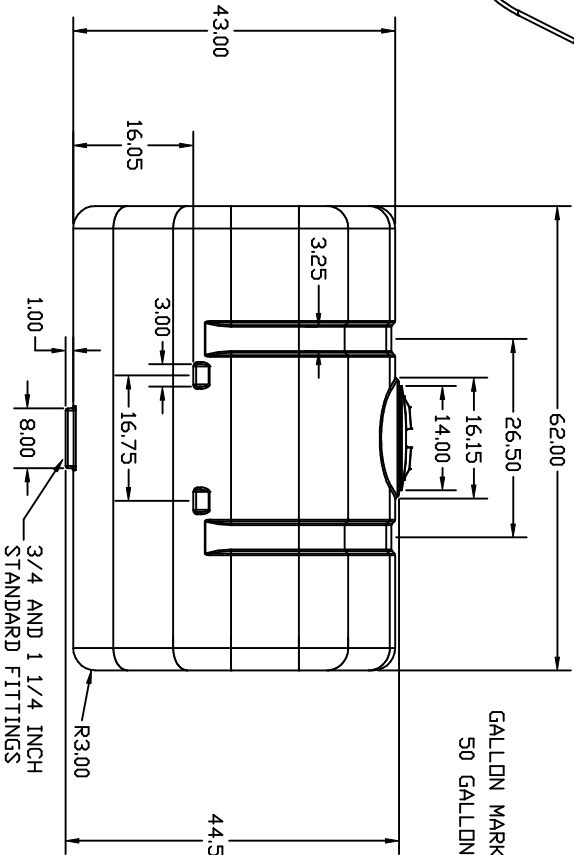
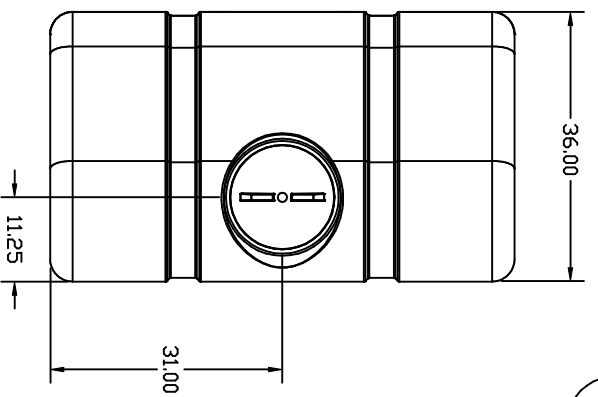
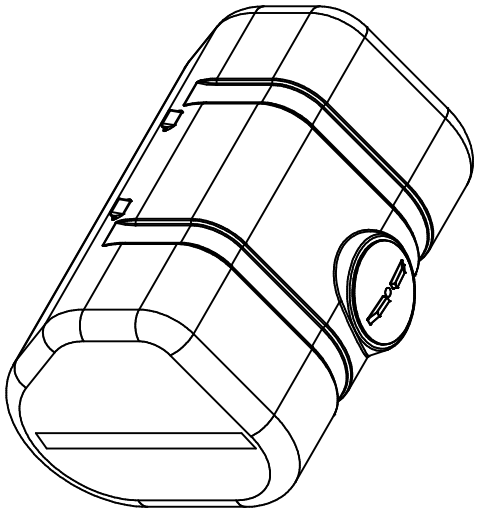
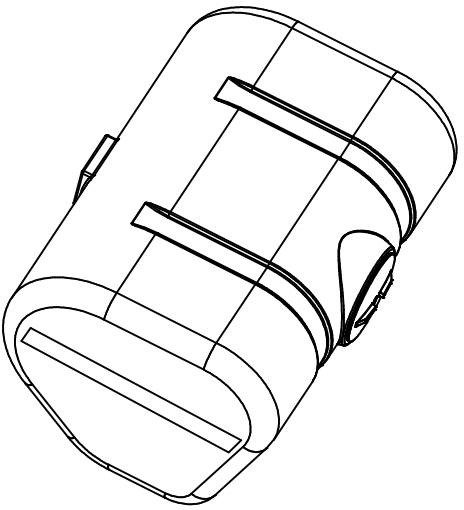

ALL RADII ARE 0.3 UNLESS OTHERWISE SPECIFIED

GALLON MARKERS EACH END
50 GALLON INCREMENTS

REV	DESCRIPTION	DATE	APPRD
B	RELOCATED GAL. MARKERS	5/18/06	
A	REVISE PART NUMBER	12/14/05	

DRAWN / DATE	NVE 8/17/05
APPRD. / DATE	REH/1/9/06
MATERIAL	POLYETHYLENE REFERENCE MATERIAL DATA SHEET FOR SPECIFIC PROPERTIES.
NOTES:	1. NOM. WALL @ 280 2. SHOT WEIGHT 107 LBS.

ALL DIMENSIONS ARE IN DECIMAL INCHES TOLERANCES UNLESS OTHERWISE SPECIFIED	± 1% @ 68° F
---	--------------

THIRD ANGLE PROJECTION ANSI 14.5M	SCALE	N.S.
CLIENT / DESCRIPTION	PART NO.	TD0300-36



ACE ROTO-MOLD
A DIVISION OF DEN HARTOG INDUSTRIES, INC.
4018 HWY. 60 BLYD., BOX 421, HOSPERS, IOWA 51238

300 GALLON TEAR DROP TANK