

© DEN HARTOG INDUSTRIES, INC.

Copyright. All information furnished within this document, electronic file or design correspondence is the property of Den Hartog industries, Inc. and shall not be used, disclosed to others or copied without the expressed written consent of Den Hartog Industries, Inc.

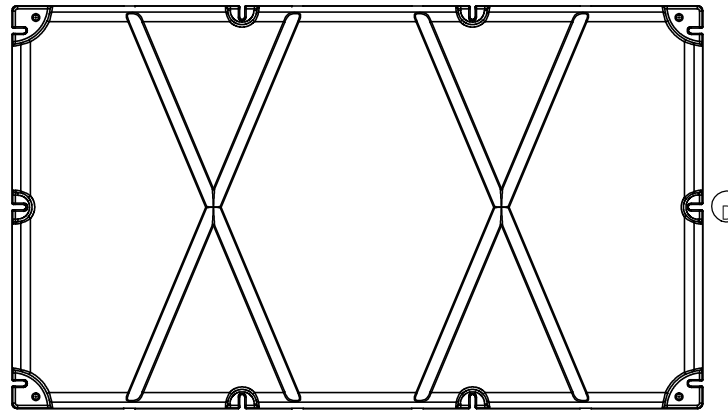
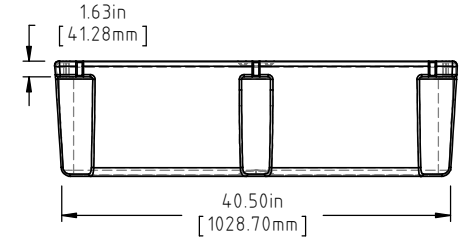
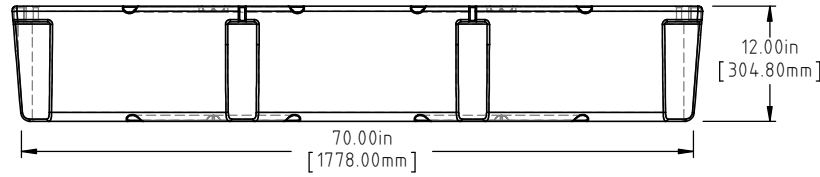
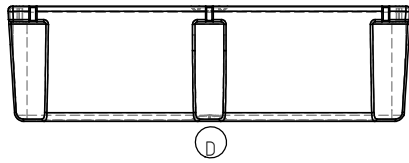
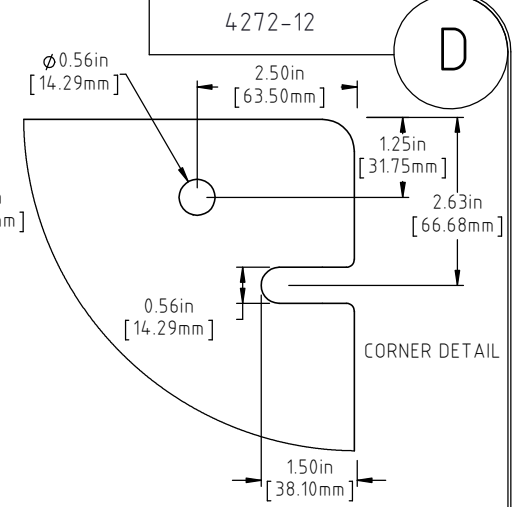
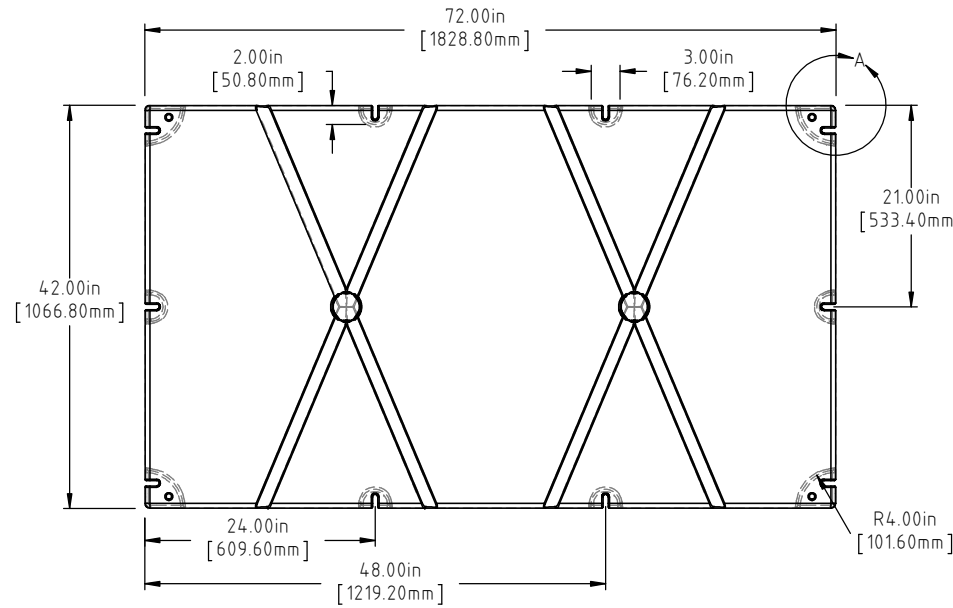

(A)(C) NOTE: BUOYANCY IS 1166 LBS.(528.89 KG)

D	BOTTOM AND SIDE VIEWS ADDED TO PRINT	ADH 12/4/14	2971
C	80 LBS WAS 70 LBS, 1166 LBS WAS 1159 LBS	ADH 6/25/12	2420
B	METRIC DIMENSIONS ADDED	ADH 6/18/08	1685
A	ADD BUOYANCY NOTE	GWC 1/10/07	
A	CHANGE WEIGHTS FF WAS 72	GWC 1/10/07	
REV	DESCRIPTION	BY / DATE	CCN

DRAWN / DATE	MATERIAL
REH 10/15/02	POLYETHYLENE
APPRD. / DATE	
ADH 11/5/07	



**Den Hartog**  
INDUSTRIES, INC.

Ace Roto-Mold Injection Molding Blow Molding Sowjoy

4010 HOSPERS DRIVE S. BOX 425, HOSPERS, IOWA 51238-0425

ALL DIMENSIONS ARE IN DECIMAL INCHES  
TOLERANCES UNLESS OTHERWISE SPECIFIED  
POLYETHYLENE METAL  
DECIMAL ± .125"  
FRACTION ± 1/4"  
ANGLE ± 1°  
±1% @ 68°F

THIRD ANGLE PROJECTION  
ANSI 14.5M

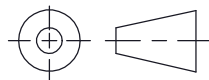

SHOT WEIGHT: 50 LBS. (22.68 KG.)	NOTES: (A)(C) 1.) AF 50 LBS. (22.68 KG.) 2.) FF 80 LBS. (36.29 KG.) 3.) 0.130 IN (3.30 mm) NOM. WALL
SHIPPING WEIGHT: SEE NOTES	
FINISH:	

DESCRIPTION	42 X 72 X 12 FLOAT
SCALE	N.S.
PART NO.	4272-12