

Copyright. All information furnished within this document, electronic file or design correspondence is the property of Den Hartog industries, Inc. and shall not be used, disclosed to others or copied without the expressed written consent of Den Hartog Industries, Inc.

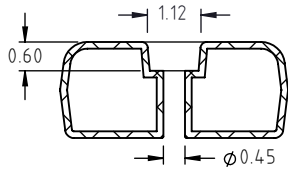

SECTION B-B
SCALE 1:4

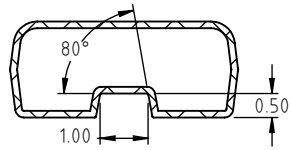

SECTION A-A
SCALE 1:4



SECTION C-C
SCALE 1:5.5

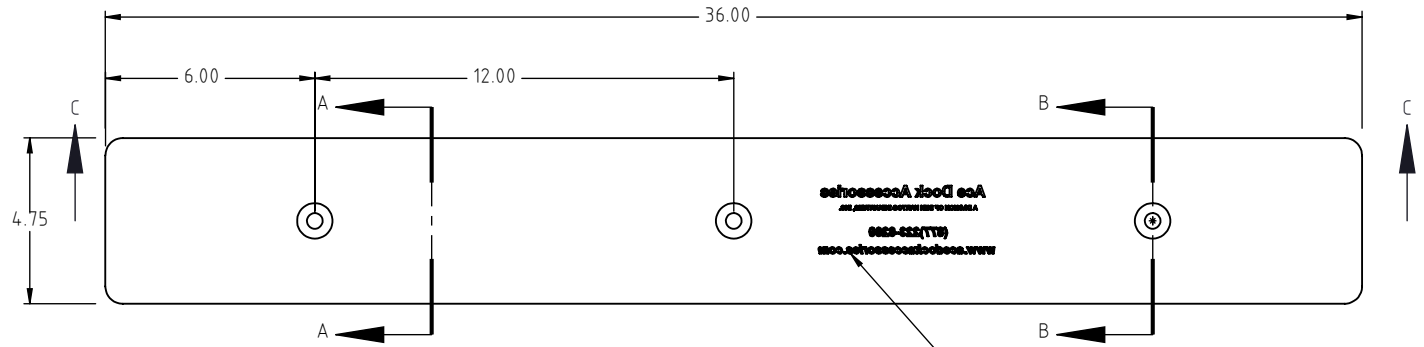

FLATNESS OF FRONT OR BACK SURFACES TO BE WITHIN 0.50"

ACE INFORMATION LOCATION

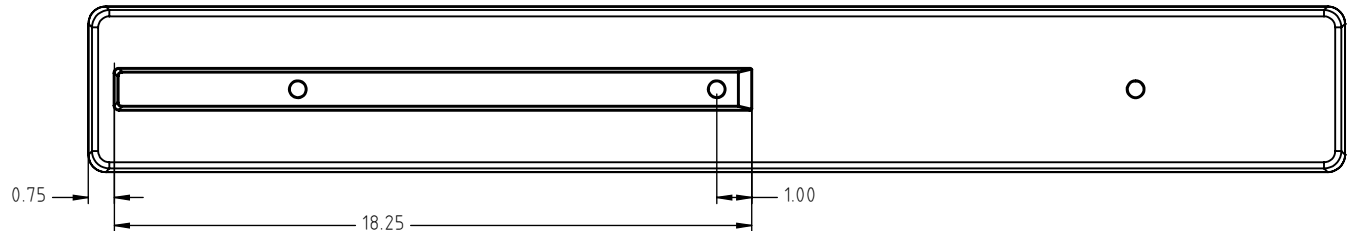
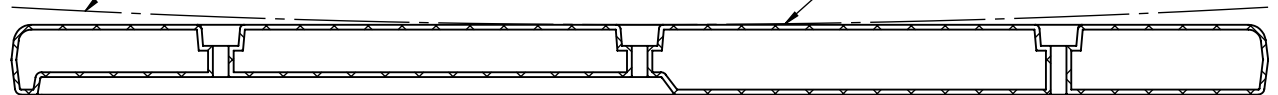

H	TEMPLATE & MATERIAL UPDATE	BES	7/10/2023	4443	DRAWN / DATE	MATERIAL :
G	FIXED SECTION VIEWS, ADDED MATERIAL CHART, UPDATED PRINT	HLN	2/18/2021	4091	REH 2/3/2003	HDPE OR EQUIVALENT
F	MATERIAL ADDED TO PRINT, MATERIAL UPDATED	HLN	4/8/2020	3941	APPRD. / DATE	REFERENCE MATERIAL
REV.	DESCRIPTION	BY	DATE	CCN	REH 2/3/2003	DATA SHEET FOR
ALL DIMENSIONS ARE IN DECIMAL INCHES TOLERANCES UNLESS OTHERWISE SPECIFIED		THIRD ANGLE PROJECTION ANSI 14.5M		SHOT WEIGHT: 2.0 LBS		NOTES:
POLYETHYLENE		METAL		SHIPPING WEIGHT:		1.) NOM. WALL @ .140
±1% @ 68°F		DECIMAL ± .125" FRACTION ± 1/4" ANGLE ± 1°		FINISH:		2.) COMPOUNDED U.V
						3.) BLACK OR WHITE COLOR



Den Hartog
INDUSTRIES, INC.

Ace Roto-Mold • Injection Molding • Blow Molding • Sowjoy
4010 HOSPERS DRIVE S. BOX 425, HOSPERS, IOWA 51238-0425

DESCRIPTION BLOW-MOLDED FLAT BACK CUSHION-3 FEET LONG		
SCALE N.S.	PART NO. DCBM3-FLAT	SHEET 1 OF 1