

Copyright. All information furnished within this document, electronic file or design correspondence is the property of Den Hartog Industries, Inc. and shall not be used, disclosed to others or copied without the expressed written consent of Den Hartog Industries, Inc.

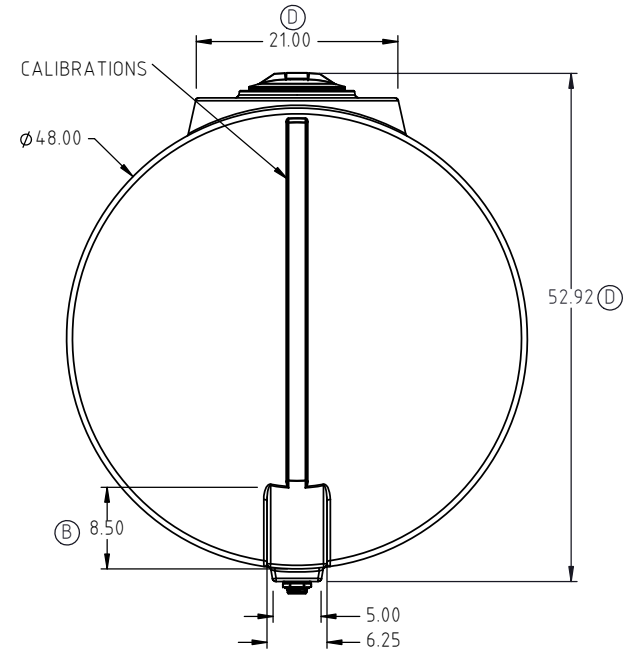

1-1/4" AND 3/4" FITTINGS ARE STANDARD

D	9.38 WAS 8.00, 1.31 WAS 1.00, 21.00 WAS 19.00, 77.69 WAS 78.50, 52.92 WAS 52.55	ADH	7/25.2023	4448	DRAWN / DATE	MATERIAL :
C	UPDATED DRAWING	HLN	6/7/2021	4132	NVE 6/9/2005	10420
B	END SUMPS ENLARGED	REH	11/5/10	2127	APPRD. / DATE	
REV.	DESCRIPTION	BY	DATE	CCN	DHJ 6/21/2005	
ALL DIMENSIONS ARE IN DECIMAL INCHES TOLERANCES UNLESS OTHERWISE SPECIFIED		THIRD ANGLE PROJECTION ANSI 14.5M		SHOT WEIGHT: 122 LBS.	NOTES:	
POLYETHYLENE	METAL DECIMAL ± .125" FRACTION ± 1/4" ANGLE ± 1°			SHIPPING WEIGHT: 124 LBS.	NOMINAL WALL THICKNESS: 0.210"	
±1% @ 68°F				FINISH:		

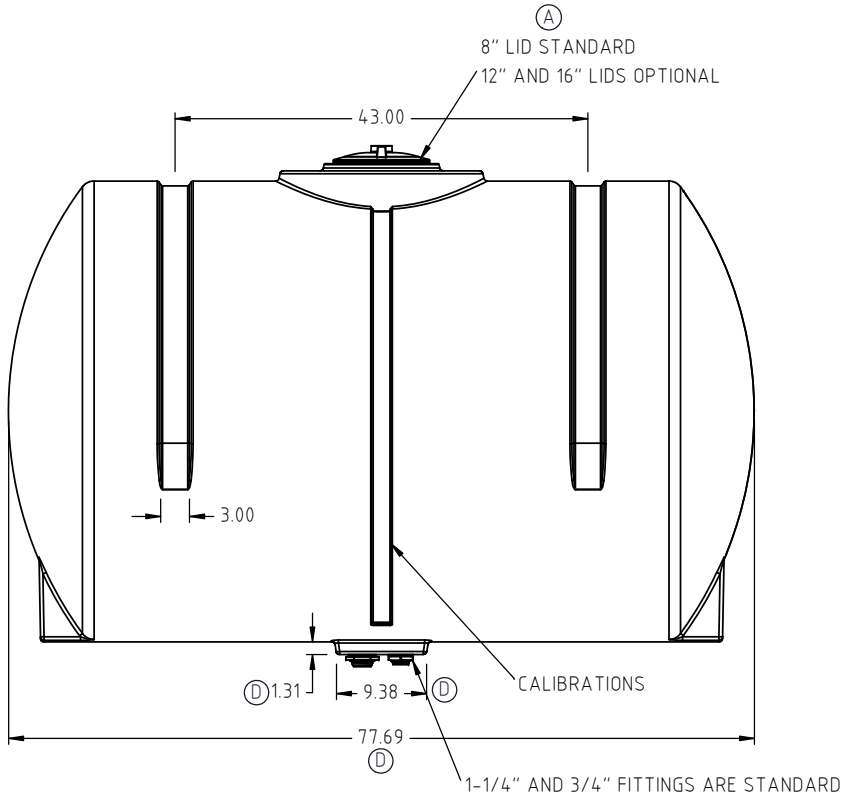
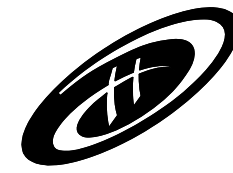

**Den Hartog
INDUSTRIES, INC.**

Ace Roto-Mold • Injection Molding • Blow Molding • Sowjoy
4010 HOSPERS DRIVE S. BOX 425, HOSPERS, IOWA 51238-0425

DESCRIPTION 500 GALLON HORIZONTAL TANK		SHEET 1 OF 1	
SCALE N.S.	PART NO. HZ0500-48		