

Copyright. All information furnished within this document, electronic file or design correspondence is the property of Den Hartog industries, Inc. and shall not be used, disclosed to others or copied without the expressed written consent of Den Hartog Industries, Inc.

(F) (G)
8 INCH LID & RING #10525
(5" THREADED LID OR 7"
THREADED LID AVAILABLE.)

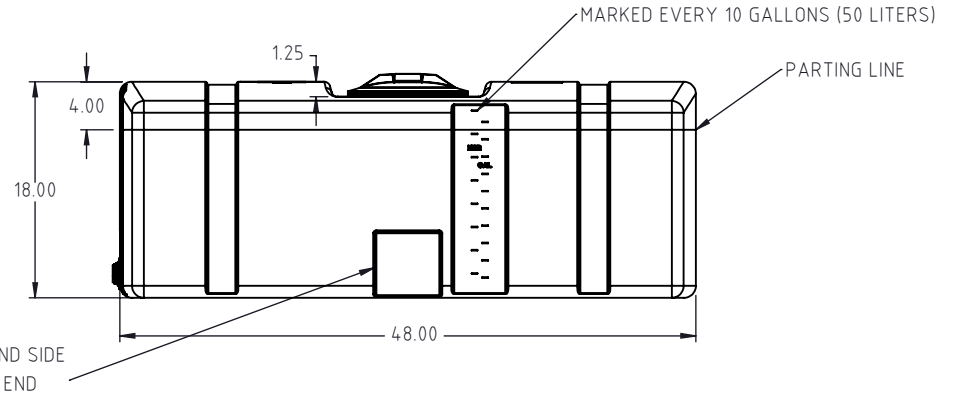
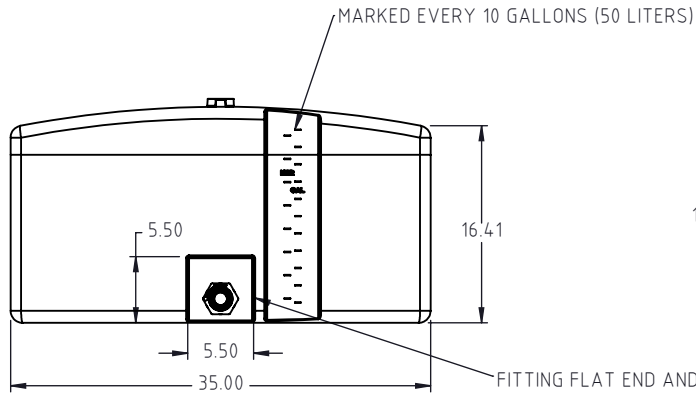
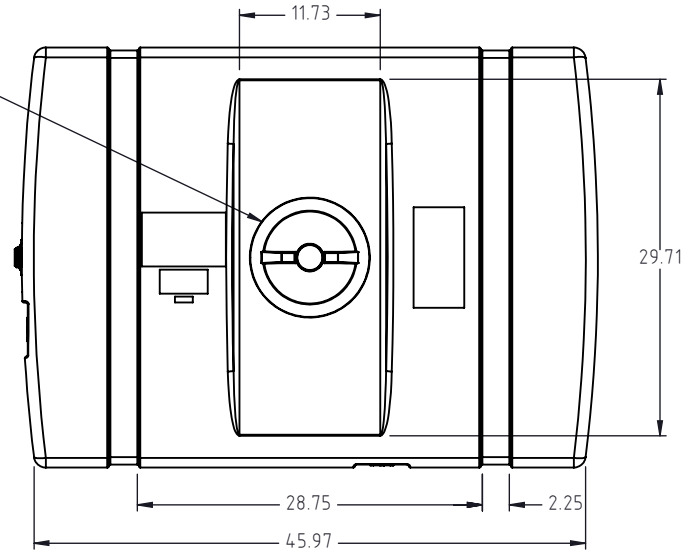

FITTING FLAT END AND SIDE
1 INCH STANDARD IN END

G	REMOVED 5" HINGED LID	NHW 10/21/20	4062
F	8" LID MADE STANDARD	NHW 9/2/20	4019
E	ADDED 5", 7", 8" LID OPTIONS	DHJ 1/25/12	2375
D	PART NUMBER UPDATED	ADH 8/19/08	1700
C	LID RECESS ADDED	3/7/06	
B	CHANGED WEIGHT TO 58 LB	2/10/06	
A	CHANGE PRINT TO MATCH PART	2/9/06	
REV	DESCRIPTION	BY / DATE	CCN

DRAWN / DATE	MATERIAL
DHJ 6/14/05	HDPE OR EQUIVALENT REFERENCE MATERIAL DATA SHEET FOR SPECIFIC PROPERTIES.
APPRD. / DATE	
ADH 11/19/07	



Den Hartog
INDUSTRIES, INC.

Ace Roto-Mold Injection Molding Blow Molding Sowjoy

4010 HOSPERS DRIVE S. BOX 425, HOSPERS, IOWA 51238-0425

ALL DIMENSIONS ARE IN DECIMAL INCHES
TOLERANCES UNLESS OTHERWISE SPECIFIED

POLYETHYLENE	METAL
±1% @ 68°F	DECIMAL ± .125" FRACTION ± 1/4" ANGLE ± 1°

THIRD ANGLE PROJECTION
ANSI 14.5M

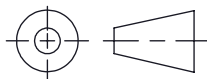

SHOT WEIGHT:	58.00 LBS.
SHIPPING WEIGHT:	
FINISH:	

NOTES:
1.) NOM. WALL @ .260
2.) NATURAL OR YELLOW COLOR

DESCRIPTION		110 GAL. LOW PROFILE RECTANGULAR TANK	
SCALE	N.S.	PART NO.	LP0110-RT