

Copyright. All information furnished within this document, electronic file or design correspondence is the property of Den Hartog Industries, Inc. and shall not be used, disclosed to others or copied without the expressed written consent of Den Hartog Industries, Inc.

CAUTION LABEL 14676

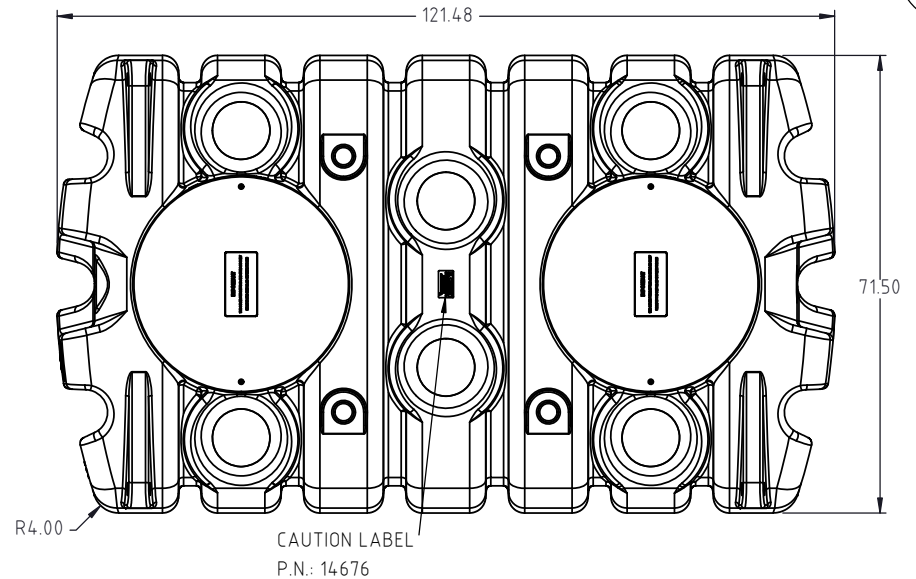

STANDARD TANK SENT WITH TWO 19465 SHIPPING COVERS BUT BURIAL LID(S) AND/OR RISER(S) REQUIRED FOR FINAL INSTALLATION.

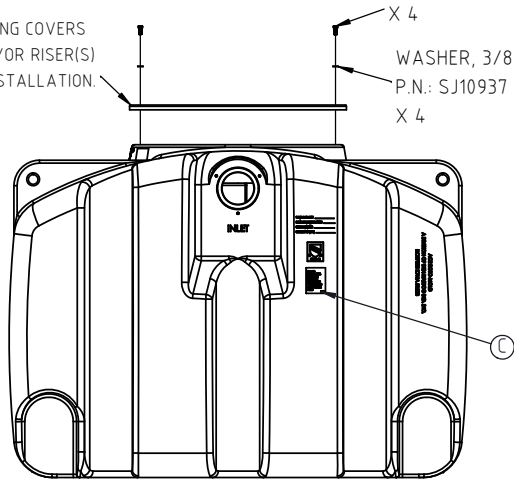

BOLT, 3/8" X 1" HEX GR 5 ZINC  
P.N.: 10089  
X 4  
WASHER, 3/8" FLAT ZINC  
P.N.: SJ10937  
X 4

UPC SYMBOL MOLD ON GRAPHIC  
P.N. 11331  
(A)

INLET SIDE

INSTALLED 4" PVC SUPPORTS  
P.N.: 14682  
X 2

INSTALLED DIVIDERS  
P.N.: 14615 & 14616  
X 2 (EACH)

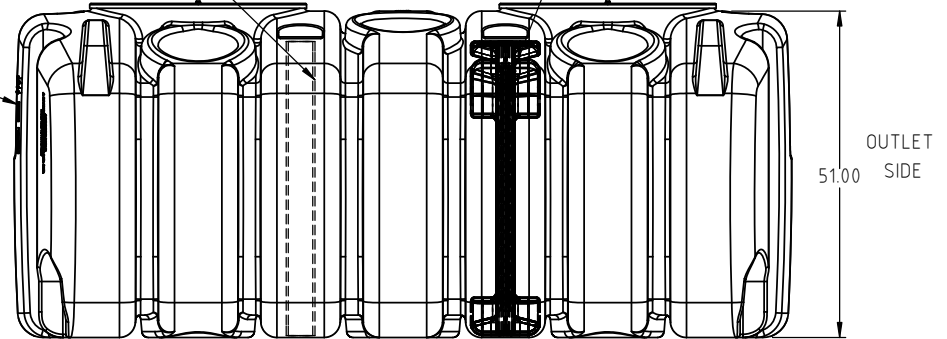

OUTLET SIDE

C	MOLDED IN INFORMATION REMOVED FROM PRINT. 15267 ADDED.	ADH	1/11/2022	4229	DRAWN / DATE	MATERIAL :
B	602.00 LBS. WAS 533.00 LBS.	ADH	11/8/2018	3665	ADH 12/2/2016	
A	11331 NOTE ADDED TO THE PRINT.	ADH	5/7/2018	3553	APPRD. / DATE	
REV.	DESCRIPTION	BY	DATE	CCN	REH 7/19/2017	
ALL DIMENSIONS ARE IN DECIMAL INCHES TOLERANCES UNLESS OTHERWISE SPECIFIED		THIRD ANGLE PROJECTION ANSI 14.5M		SHOT WEIGHT:		NOTES:
POLYETHYLENE		METAL		SHIPPING WEIGHT: 602.00 LBS.		
±1% @ 68°F		DECIMAL ± .125" FRACTION ± 1/4" ANGLE ± 1°		FINISH:		

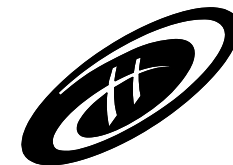

**Den Hartog INDUSTRIES, INC.**

Ace Roto-Mold • Injection Molding • Blow Molding • Sowjoy  
4010 HOSPERS DRIVE S. BOX 425, HOSPERS, IOWA 51238-0425

DESCRIPTION 1000 GALLON LOW PROFILE TWO COMPARTMENT SEPTIC TANK ASSEMBLY AS SHIPPED.		
SCALE N.S.	PART NO. LPS-1000-2	SHEET 1 OF 2

Copyright. All information furnished within this document, electronic file or design correspondence is the property of Den Hartog Industries, Inc. and shall not be used, disclosed to others or copied without the expressed written consent of Den Hartog Industries, Inc.

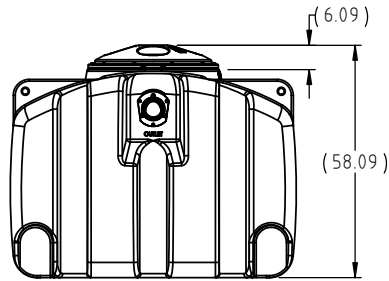

OPTIONAL  
BURIAL LID ASSEMBLY  
P.N.= ACT-16053BK  
SHOWN

LID/COVER OPTIONS.  
(TWO COMPLETE COVERS  
REQUIRED FOR INSTALLATION).

- 1.) BURIAL LID ASSEMBLY  
P.N.=ACT-16053BK
- 2.) 16" GROUND ACCESS RISER  
P.N.=ACT-16054BK
- 3.) 28" GROUND ACCESS RISER  
P.N.=ACT-16052BK
- 4.) 7" EXTENSION (REQUIRES RISER)  
P.N.=AST19365
- 5.) 16" EXTENSION (REQUIRES RISER)  
P.N.=AST19212

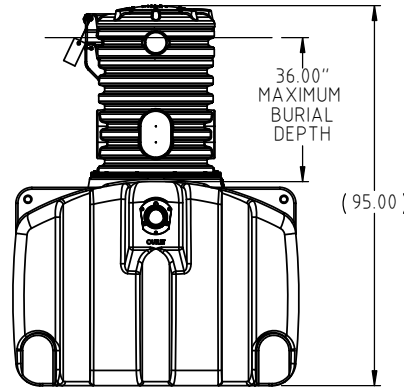

OPTIONAL  
28" GROUND ACCESS RISER (ACT-16052BK)  
AND 7" EXTENSION (AST19365)  
SHOWN

KEY	PART NUMBER	DESCRIPTION	QTY.
1	LPS-1000	1000 GAL LOW PROFILE SEPTIC TANK	1
2	14616	OUTER DIVIDER	2
3	14615	INNER DIVIDER	2
4	AST19153	CLAMP, STABILIZER	2
5	10087	BOLT, 1/4" X 3/4" HEX GR5 ZINC	6
6	10626	WASHER, 1/4" FLAT ZINC	6
7	14682	PIPE, 4" SEPTIC/CISTERN SUPPORT PVC	2
8	19465	ACT, CISTERN SHIPPING COVER	2
9	SJ10937	WASHER, 3/8" FLAT ZINC	8
10	10089	BOLT, 3/8" X 1" HEX GR 5 ZINC	4
11	14676	LABEL, CAUTION SEPTIC	1
12	10007	BOLT, 3/8" X 2" HEX GR 5 ZINC	4
13	15267	LABEL, 1000 GAL LPS	1

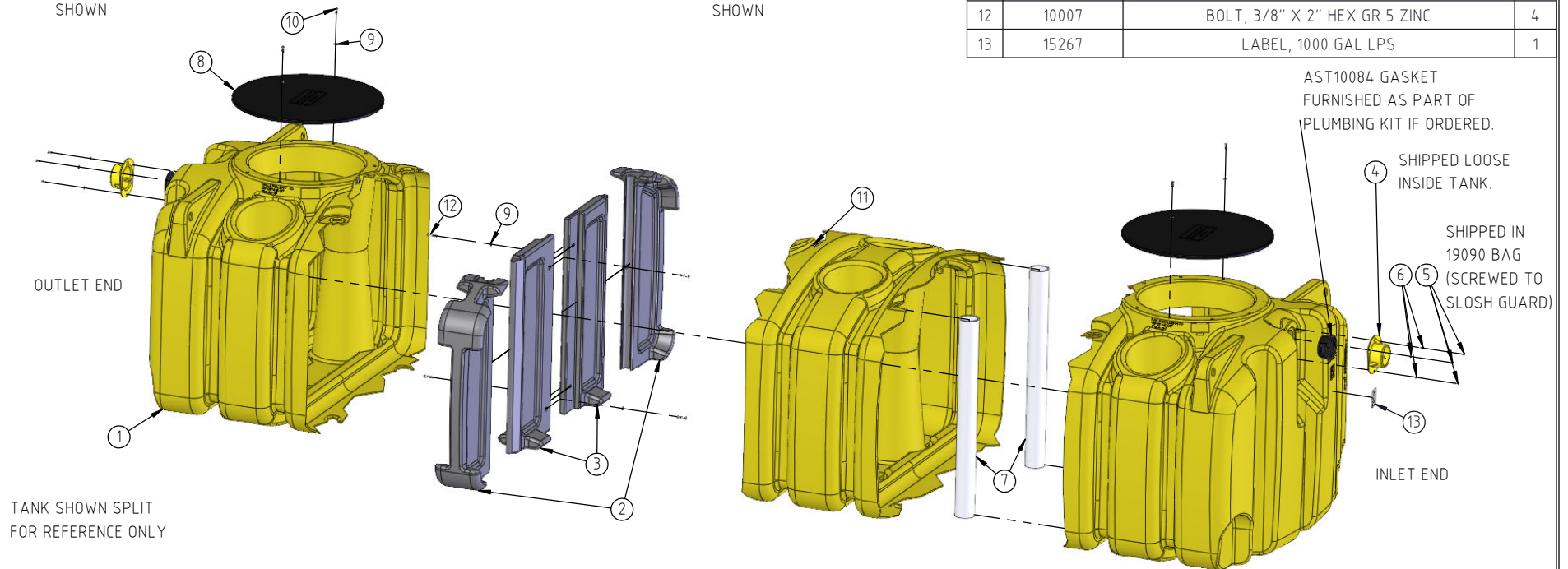

DRAWN / DATE ADH 12/2/2016	MATERIAL :
APPRD. / DATE REH 7/19/2017	
SHOT WEIGHT:	NOTES:
SHIPPING WEIGHT:	
FINISH:	

REV.	DESCRIPTION	BY	DATE	CCN
	ALL DIMENSIONS ARE IN DECIMAL INCHES TOLERANCES UNLESS OTHERWISE SPECIFIED			
	POLYETHYLENE			
	METAL DECIMAL ± .125" FRACTION ± 1/4" ANGLE ± 1°			
	±1% @ 68°F			

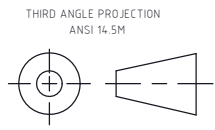

**Den Hartog  
INDUSTRIES, INC.**

Ace Roto-Mold • Injection Molding • Blow Molding • Sowjoy  
4010 HOSPERS DRIVE S. BOX 425, HOSPERS, IOWA 51238-0425

DESCRIPTION 1000 GALLON LOW PROFILE TWO COMPARTMENT SEPTIC TANK ASSEMBLY AS SHIPPED.		
SCALE N.S.	PART NO. LPS-1000-2	SHEET. 2 OF 2