

© DEN HARTOG INDUSTRIES, INC.

Copyright. All information furnished within this document, electronic file or design correspondence is the property of Den Hartog Industries, Inc. and shall not be used, disclosed to others or copied without the expressed written consent of Den Hartog Industries, Inc.

| KEY | PART NUMBER | DESCRIPTION | QTY. |
|-----|-------------|--------------------------------|------|
| 1 | 19464 | GASKET, 28" | 1 |
| 2 | 14687 | CISTERN, 28" EXTENSION-BLACK | 1 |
| 3 | AST19211 | LID, 24" SEPTIC BLACK W/GASKET | 1 |
| 4 | AST19365 | EXTENSION, 7" SEPTIC BLACK | 1 |
| 5 | 19463 | LABEL, CAUTION | 1 |
| 6 | 19318 | TIE STRAP, 14" NYLON BLACK | 2 |
| 7 | 11113 | TAG, 6-1/4" X 3-1/8" TYVEK | 1 |
| 8 | 10357 | LABEL, BARCODE 4" X 2" | 1 |

LPS-14684

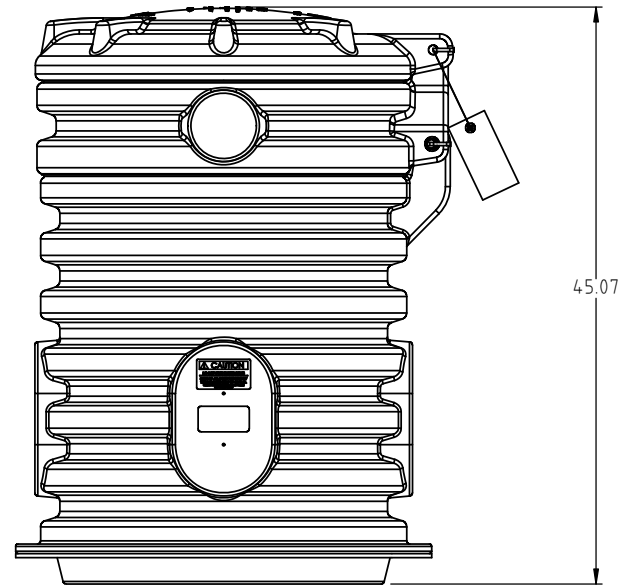
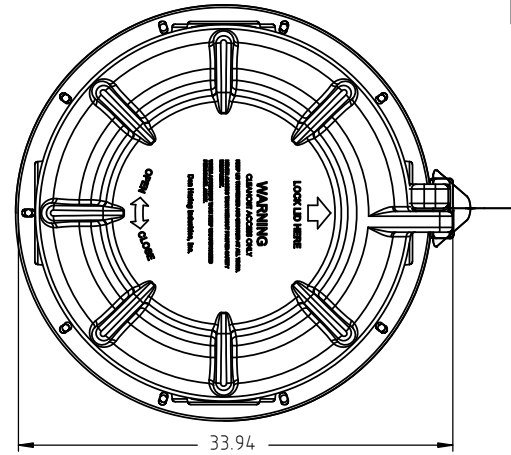
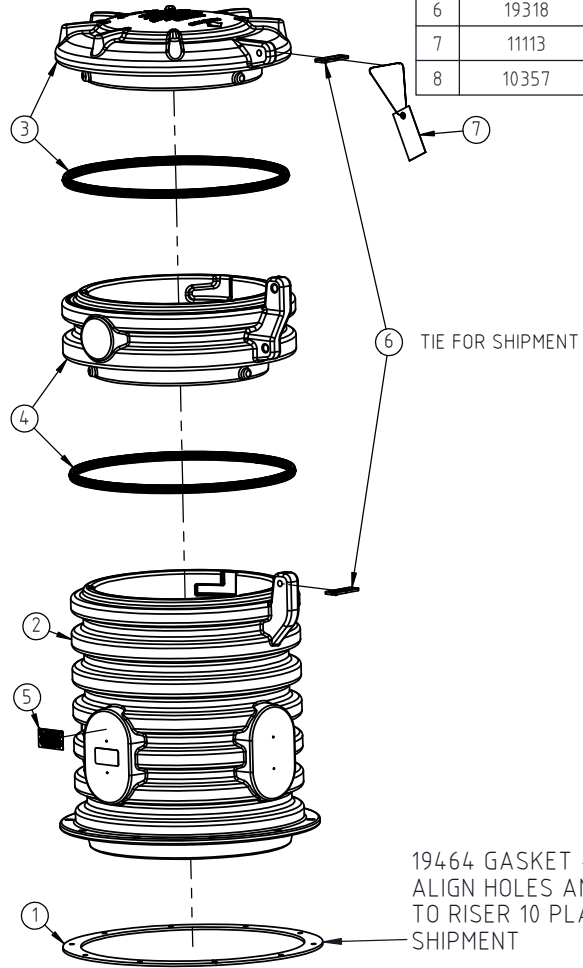

NOTE: STRETCH WRAP FOR SHIPMENT

| | | | | | |
|-----|---|---|--------------------------------------|-------------------------------|----------|
| | | | | DRAWN / DATE ADH 12/15/16 | MATERIAL |
| | | | | APPRD. / DATE REH 7/19/17 | |
| REV | DESCRIPTION | BY / DATE | CCN | SHOT WEIGHT: | NOTES: |
| | ALL DIMENSIONS ARE IN DECIMAL INCHES TOLERANCES UNLESS OTHERWISE SPECIFIED | | | SHIPPING WEIGHT: 69.00 LB. | |
| | POLYETHYLENE ±1% @ 68°F | METAL DECIMAL ± .125" FRACTION ± 1/4" ANGLE ± 1° | THIRD ANGLE PROJECTION ANSI 14.5M | FINISH: | |



Den Hartog
INDUSTRIES, INC.

Ace Roto-Mold Injection Molding Blow Molding Sowjoy

4010 HOSPERS DRIVE S. BOX 425, HOSPERS, IOWA 51238-0425

| | | |
|-------------|---------------------------|-----------------------|
| DESCRIPTION | 36" SEPTIC RISER ASSEMBLY | |
| SCALE | N.S. | PART NO. LPS-14684 |