

Copyright. All information furnished within this document, electronic file or design correspondence is the property of Den Hartog Industries, Inc. and shall not be used, disclosed to others or copied without the expressed written consent of Den Hartog Industries, Inc.

PART NUMBER	DESCRIPTION	MATERIAL	SHOT WEIGHT	SHIPPING WEIGHT
AFLS2448-20	AIR FLOAT, 24 X 48 X 20	10548	30 LBS.(13.61 KG.)	30 LBS.(13.61 KG.)
FFLS2448-20	FOAM FLOAT, 24 X 48 X 20			44 LBS.(19.96 KG.)

LS2448-20

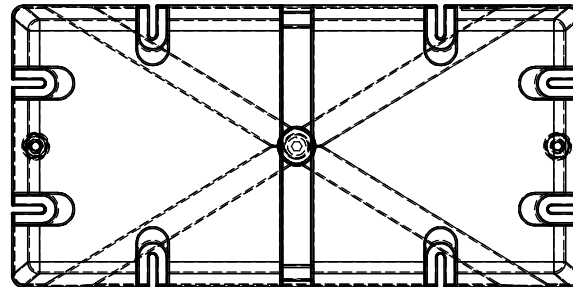
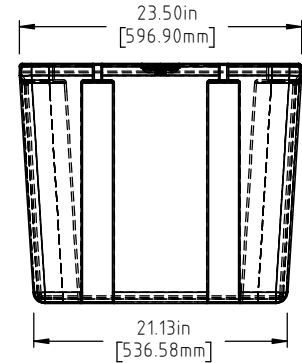
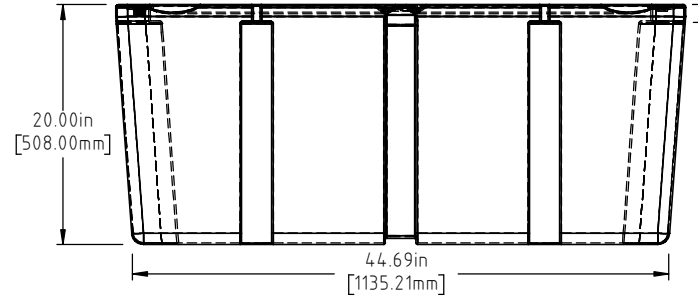
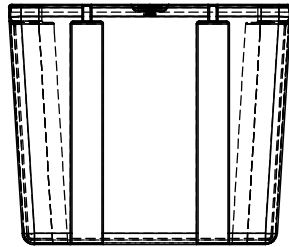
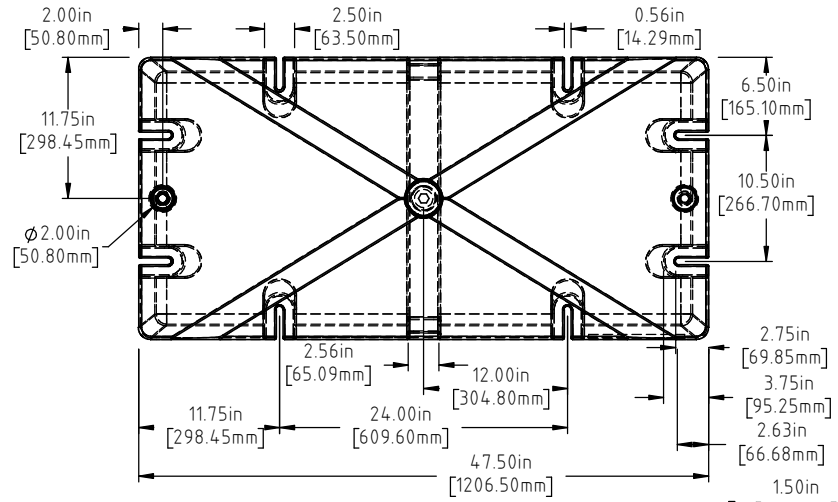

NOTE: BUOYANCY NOTE: BUOYANCY IS 602 LBS.(273.06 KG)

DRAWN / DATE ADH 3/6/2019	MATERIAL  POLYETHYLENE
APPROD. / DATE REH 5/22/2019	
SHOT WEIGHT: SEE TABLE.	NOTES:  0.150 (3.81mm) NOM. WALL
SHIPPING WEIGHT: SEE TABLE.	
FINISH:	



**Den Hartog**  
**INDUSTRIES, INC.**

Ace Roto-Mold • Injection Molding • Blow Molding • Sowjoy  
4010 HOSPERS DRIVE S. BOX 425, HOSPERS, IOWA 51238-0425

REV.	DESCRIPTION	BY	DATE	CCN

ALL DIMENSIONS ARE IN DECIMAL INCHES  
TOLERANCES UNLESS OTHERWISE SPECIFIED

POLYETHYLENE ±1% @ 68°F	METAL DECIMAL ± .125" FRACTION ± 1/4" ANGLE ± 1°
----------------------------	---

THIRD ANGLE PROJECTION  
ANSI 14.5M

DESCRIPTION 24 X 48 X 20 LONG SLOT FLOAT	SCALE N.S.	PART NO. LS2448-20	SHEET 1 OF 1
---	---------------	-----------------------	-----------------