

Copyright. All information furnished within this document, electronic file or design correspondence is the property of Den Hartog industries, Inc. and shall not be used, disclosed to others or copied without the expressed written consent of Den Hartog Industries, Inc.

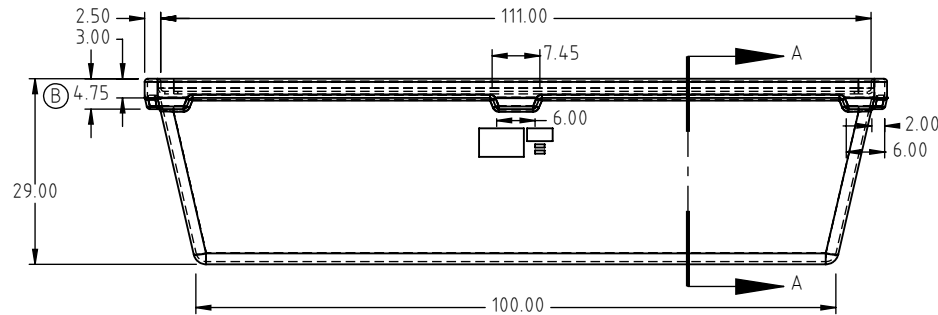

SECTION A-A
SCALE 1:30

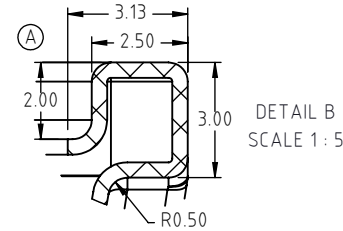
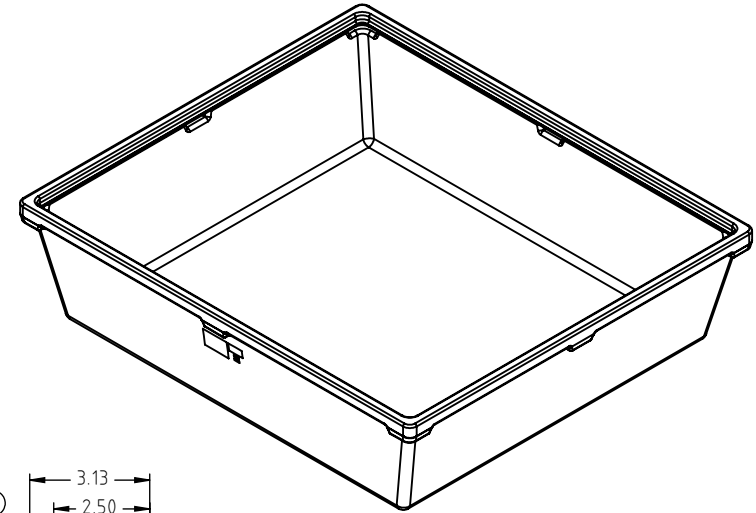
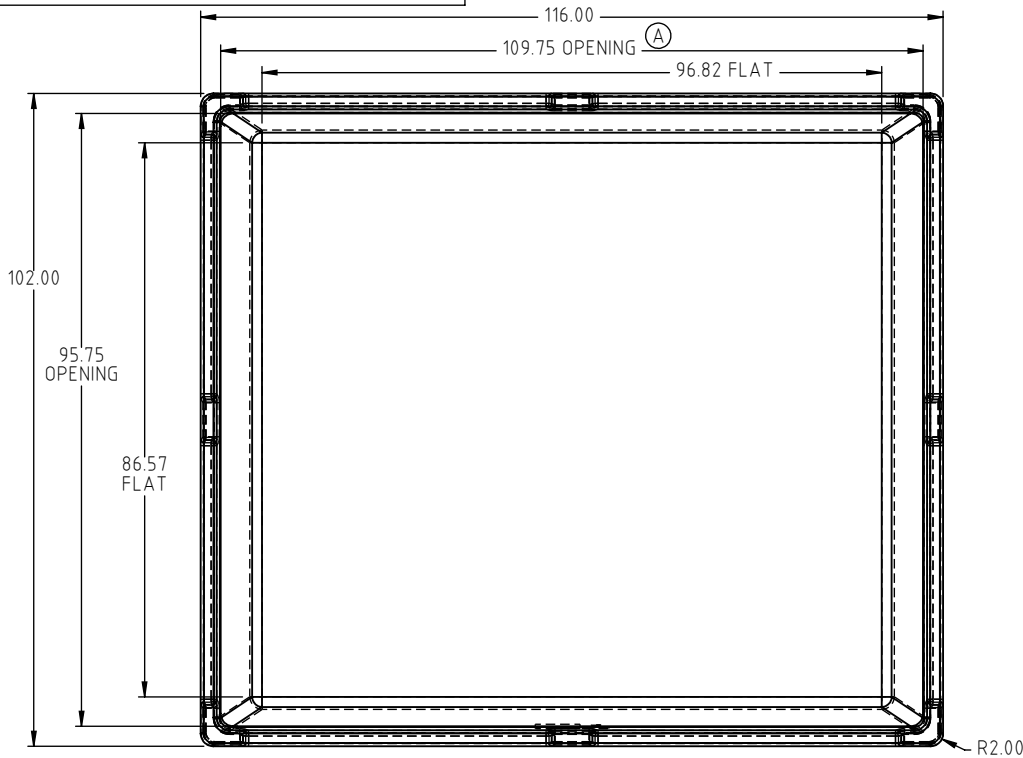
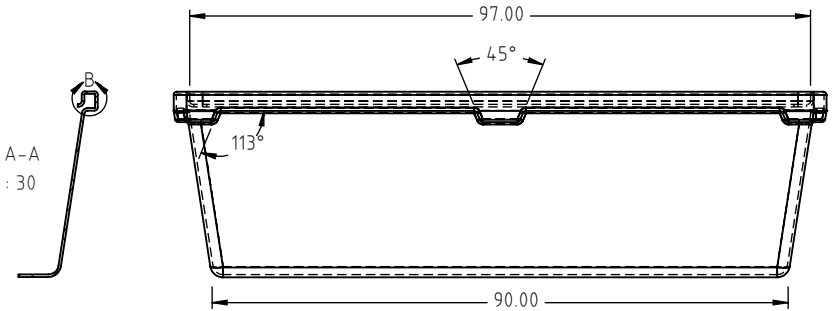

B	4.75" CORRECTED FROM 6.75"	ADH	2/11/2021	4094	DRAWN / DATE ADH 1/31/2019	MATERIAL 10538 2 MELT NATURAL RESIN
A	365 WAS 340. 325 WAS 330. 5/8" OFFSET WAS 1/4"	ADH	11/22/2019	3891	APPRD. / DATE REH 3/4/2019	
REV.	DESCRIPTION	BY	DATE	CCN		
ALL DIMENSIONS ARE IN DECIMAL INCHES TOLERANCES UNLESS OTHERWISE SPECIFIED		THIRD ANGLE PROJECTION ANSI 14.5M			SHOT WEIGHT: 365 LBS. (A)	NOTES: NOMINAL WALL THICKNESS: 0.40"
POLYETHYLENE	METAL DECIMAL ± .125" FRACTION ± 1/4" ANGLE ± 1°				SHIPPING WEIGHT: (A) 325 LBS.	
±1% @ 68°F					FINISH: NONE	



**Den Hartog
INDUSTRIES, INC.**

Ace Roto-Mold • Injection Molding • Blow Molding • Sowjoy
4010 HOSPERS DRIVE S. BOX 425, HOSPERS, IOWA 51238-0425

DESCRIPTION 1200 GALLON CONTAINMENT TANK		SHEET 1 OF 1
SCALE N.S.	PART NO. OP1200-RT	