

Copyright. All information furnished within this document, electronic file or design correspondence is the property of Den Hartog industries, Inc. and shall not be used, disclosed to others or copied without the expressed written consent of Den Hartog Industries, Inc.

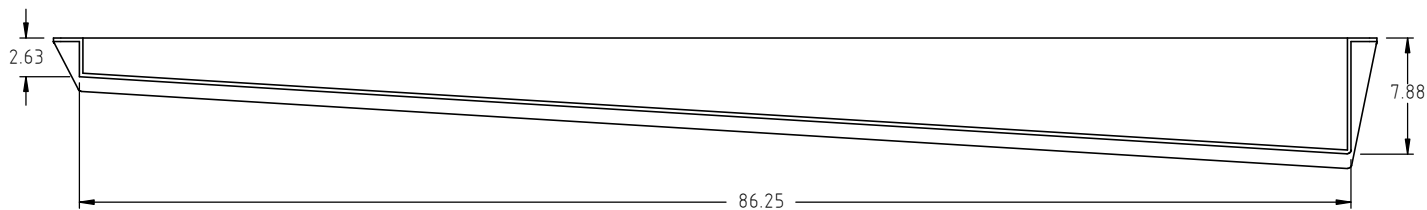

RIGHT AND LEFT POCKETS SOLD AS A PAIR (LEFT SHOWN)

				DRAWN / DATE ADH 3/5/12	MATERIAL 10552
A	20 LBS. WAS 23 LBS	ADH 10/8/12	2502	APPRD. / DATE REH 3/16/12	
REV	DESCRIPTION	BY / DATE	CCN		
ALL DIMENSIONS ARE IN DECIMAL INCHES TOLERANCES UNLESS OTHERWISE SPECIFIED		THIRD ANGLE PROJECTION ANSI 14.5M		SHOT WEIGHT: 50 LBS MAKES 2	NOTES: 1.) NOM. WALL = 0.250 2.) WHITE COLOR
POLYETHYLENE ±1% @ 68° F		METAL DECIMAL ± .125" FRACTION ± 1/4" ANGLE ± 1°		SHIPPING WEIGHT: 20 LBS.	FINISH: A

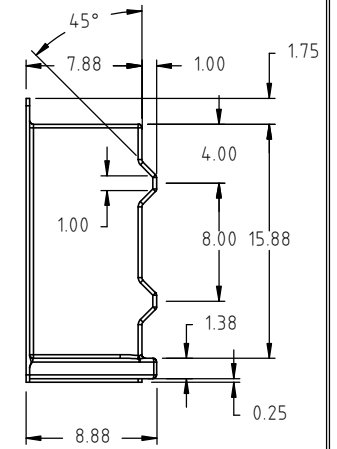
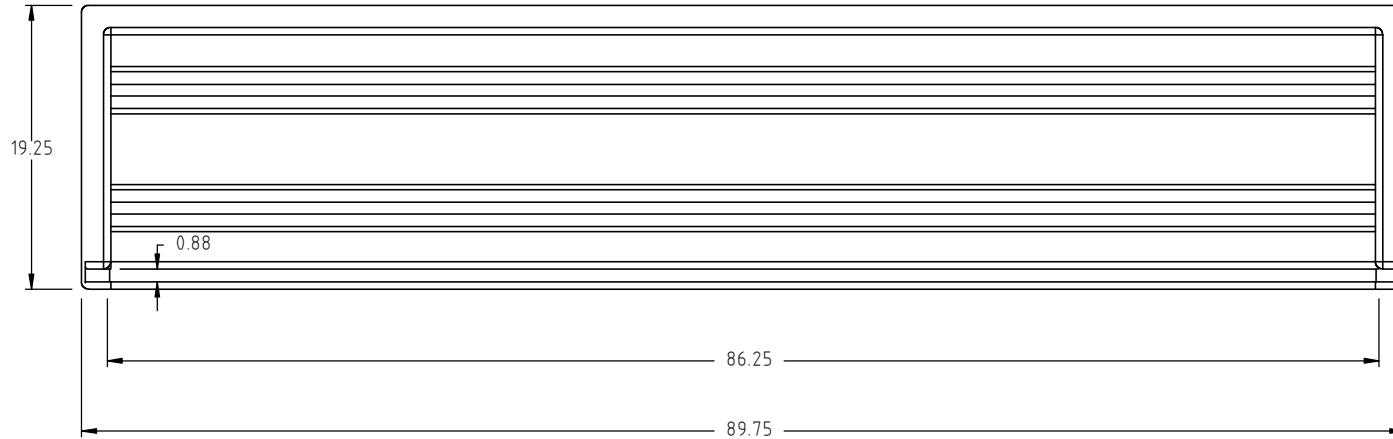
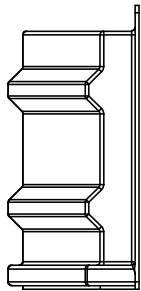
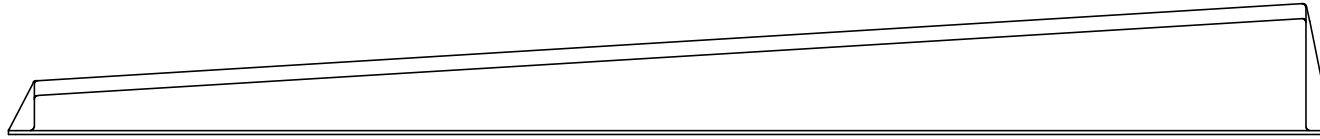

Den Hartog
INDUSTRIES, INC.

Acra Roto-Mold Injection Molding Blow Molding Sowjoy

4010 HOSPERS DRIVE S. BOX 425, HOSPERS, IOWA 51238-0425

DESCRIPTION	86" CURTAIN POCKET-PAIR	
SCALE	N.S.	PART NO. RM-19529