

© DEN HARTOG INDUSTRIES, INC.

Copyright. All information furnished within this document, electronic file or design correspondence is the property of Den Hartog Industries, Inc. and shall not be used, disclosed to others or copied without the expressed written consent of Den Hartog Industries, Inc.

KEY	PART NUMBER	DESCRIPTION	5 TANK QTY.*	4 TANK QTY.*	3 TANKS QTY.	2 TANKS QTY.	1 TANK QTY.
1	12620	1" MPT X 1" MPT X 4" NIPPLE	1	1	1	1	1
2	12621	2" MPT x 1" FPT Reducer Bushing	5	4	3	2	1
3	12622	1" MPT x 1" Hose Barb 90 Elbow	9	7	5	3	1
4	12623	1" MPT x Hose Barb Straight	4	3	2	1	-
5	12624	1" MPT x 1" MPT Coupler	4	3	2	1	-
6	12625	1" Ball Valve	5	4	3	2	1
7	12626	1" Chemical PVC Tubing x 5 ft	4	3	2	1	-
8	12627	1-1/4" S.S. Hose Clamp	8	6	4	2	-
9	12630	2 VALVE MANIFOLD WELDMENT	-	-	1	1	-
10	13526	4 VALVE MANIFOLD WELDMENT	1	1	-	-	-

ST70/120-PL

C

*=35 GALLON TANKS ONLY

35,70, 120 TOTES

NOTES:

- 1.) 3 TANK PLUMBING CONFIGURATION SHOWN. FOR SINGLE UP TO FIVE TANK CONFIGURATIONS SEE QUANTITY SCHEDULE
- 2.) SEAL ALL THREADED CONNECTIONS WITH TEFLON TAPE.
- 3.) 70 GALLON TANKS LIMITED TO 3 HIGH. 120 GALLON TANKS LIMITED TO 2 HIGH. 35 GALLON TANKS LIMITED TO 5 HIGH.

180, 240 TOTES

CUT 5 FT. TUBING TO LENGTH AS NEEDED

NOTES:

- 1.) 2 TANK PLUMBING CONFIGURATION SHOWN. FOR SINGLE TANK CONFIGURATIONS SEE QUANTITY SCHEDULE
- 2.) SEAL ALL THREADED CONNECTIONS WITH TEFLON TAPE.
- 3.) 180 AND 240 GALLON TANKS CAN ONLY BE STACKED 2 HIGH

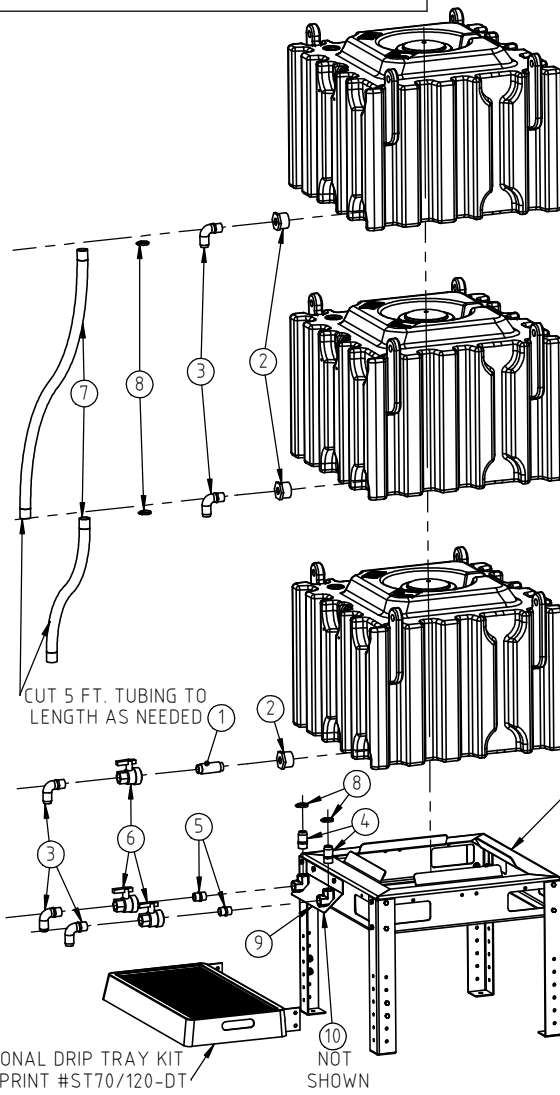

OPTIONAL SKID KIT
SEE PRINT #ST70/120-SK

OPTIONAL LEG KIT(S)
(SEE PRINT #ST024-LG (SHOWN)
OR ST036-LG (BRACES REQUIRED))

OPTIONAL DRIP TRAY KIT
SEE PRINT #ST70/120-DT
NOT SHOWN

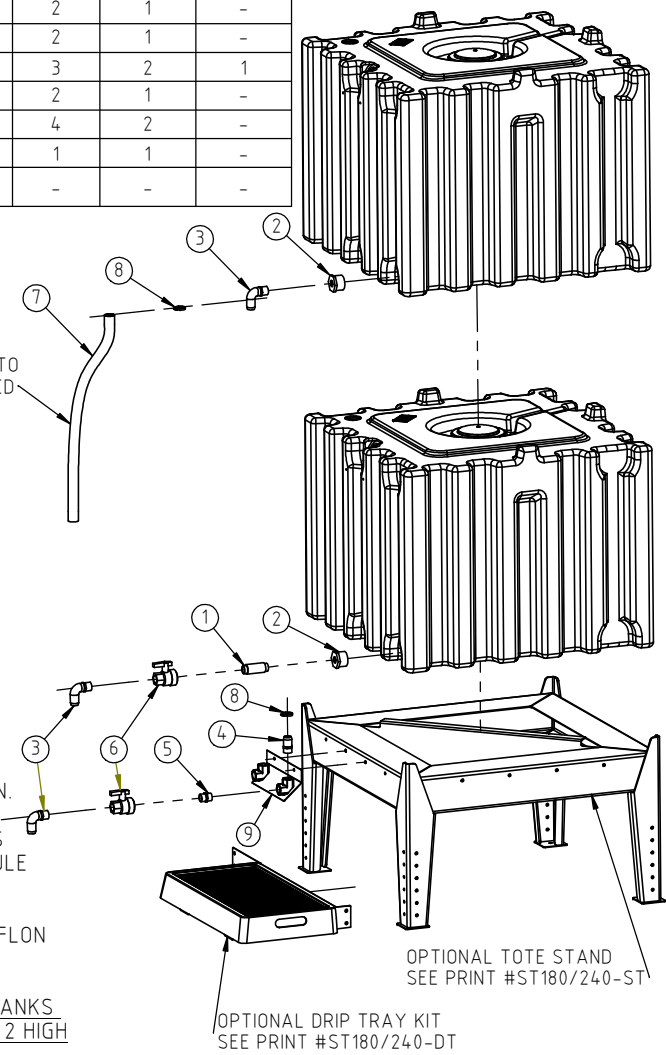

OPTIONAL TOTE STAND
SEE PRINT #ST180/240-ST

OPTIONAL DRIP TRAY KIT
SEE PRINT #ST180/240-DT

C	35,180 & 240 TOTE AND STAND OPTIONS ADDED TO PRINT	ADH 11/8/11	2284	DRAWN / DATE	MATERIAL
B	ST024-LG & ST036-LG WERE ST70/120-LG	ADH 4/18/11	2207	ADH 11/12/08	
A	36" LEG OPTION ADDED, DRAWING TEMPLATE UPDATED	ADH 4/13/11	2206	APPRD. / DATE	
REV	DESCRIPTION	BY / DATE	CCN	REH 1/6/09	
ALL DIMENSIONS ARE IN DECIMAL INCHES TOLERANCES UNLESS OTHERWISE SPECIFIED		THIRD ANGLE PROJECTION ANSI 14.5M		SHOT WEIGHT:	NOTES:
POLYETHYLENE		METAL DECIMAL ± .125" FRACTION ± 1/4" ANGLE ± 1°		SHIPPING WEIGHT:	
±1% @ 68° F				FINISH:	



Den Hartog
INDUSTRIES, INC.

Acro Roto-Mold Injection Molding Blow Molding Sowjoy

4010 HOSPERS DRIVE S. BOX 425, HOSPERS, IOWA 51238-0421

DESCRIPTION	35,70,120,180,240 GAL. TOTE PLUMBING KITS	
SCALE	N.S.	PART NO. ST70/120-PL